

ROOM CATEGORY			
	AREA	QTY	
100-CLASSROOM FACILITIES	10,966	11	
100-Classroom Facilities	389	2	
300-Office Facilities	2,704	15	
400-Study Facilities	1,199	9	
Non-Assignable Areas	8,635	27	
TOTAL:	23,893	64	
Floor Gross:	27,368		

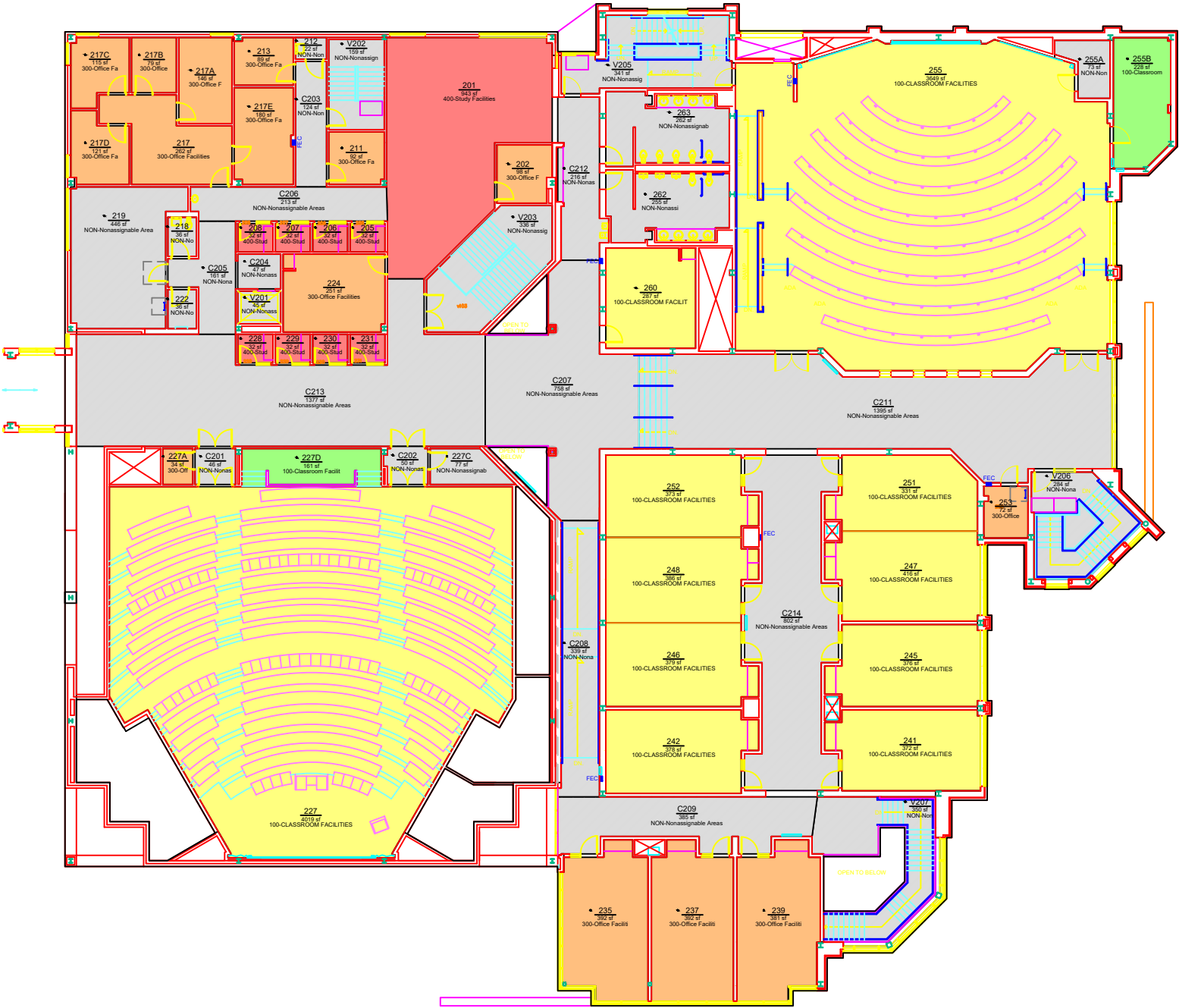

ROOM	ROOM CATEGORY
202	300-Office Facilities
205	400-Study Facilities
206	400-Study Facilities
207	400-Study Facilities
208	400-Study Facilities
211	300-Office Facilities
212	NON-Nonassignable Areas
213	300-Office Facilities
217A	300-Office Facilities
217B	300-Office Facilities
217C	300-Office Facilities
217D	300-Office Facilities
217E	300-Office Facilities
218	NON-Nonassignable Areas
219	NON-Nonassignable Areas
222	NON-Nonassignable Areas
227A	300-Office Facilities
227C	NON-Nonassignable Areas
227D	100-Classroom Facilities
228	400-Study Facilities
229	400-Study Facilities
230	400-Study Facilities
231	400-Study Facilities
235	300-Office Facilities
237	300-Office Facilities
239	300-Office Facilities
253	300-Office Facilities
255A	NON-Nonassignable Areas
255B	100-Classroom Facilities
260	100-CLASSROOM FACILITIES
262	NON-Nonassignable Areas
263	NON-Nonassignable Areas
C201	NON-Nonassignable Areas
C202	NON-Nonassignable Areas
C203	NON-Nonassignable Areas
C204	NON-Nonassignable Areas
C205	NON-Nonassignable Areas
C208	NON-Nonassignable Areas
C212	NON-Nonassignable Areas
V201	NON-Nonassignable Areas
V202	NON-Nonassignable Areas
V203	NON-Nonassignable Areas
V205	NON-Nonassignable Areas
V206	NON-Nonassignable Areas
V207	NON-Nonassignable Areas
End of chart	



Office of the  
University Architect  
Facilities Management  
1161 West Samford Ave., Building 1  
Auburn, AL 36849

ROOM CATEGORY  
Veterinary Education Center  
Level: 02

Building No.: AA\_E1405  
File Name: AA\_E1405\_02  
Last Export: 07/08/2015  
Report Created By: Ellen Doyle  
Report Date: 09/10/2018