

ROOM CATEGORY			
<div></div>	300-Office Facilities	AREA	QTY
<div></div>	900-Residential Facilities	171	2
<div></div>	Non-Assignable Areas	17,084	51
	TOTAL:	7,294	58
	Floor Gross:	24,549	111
		27,432	

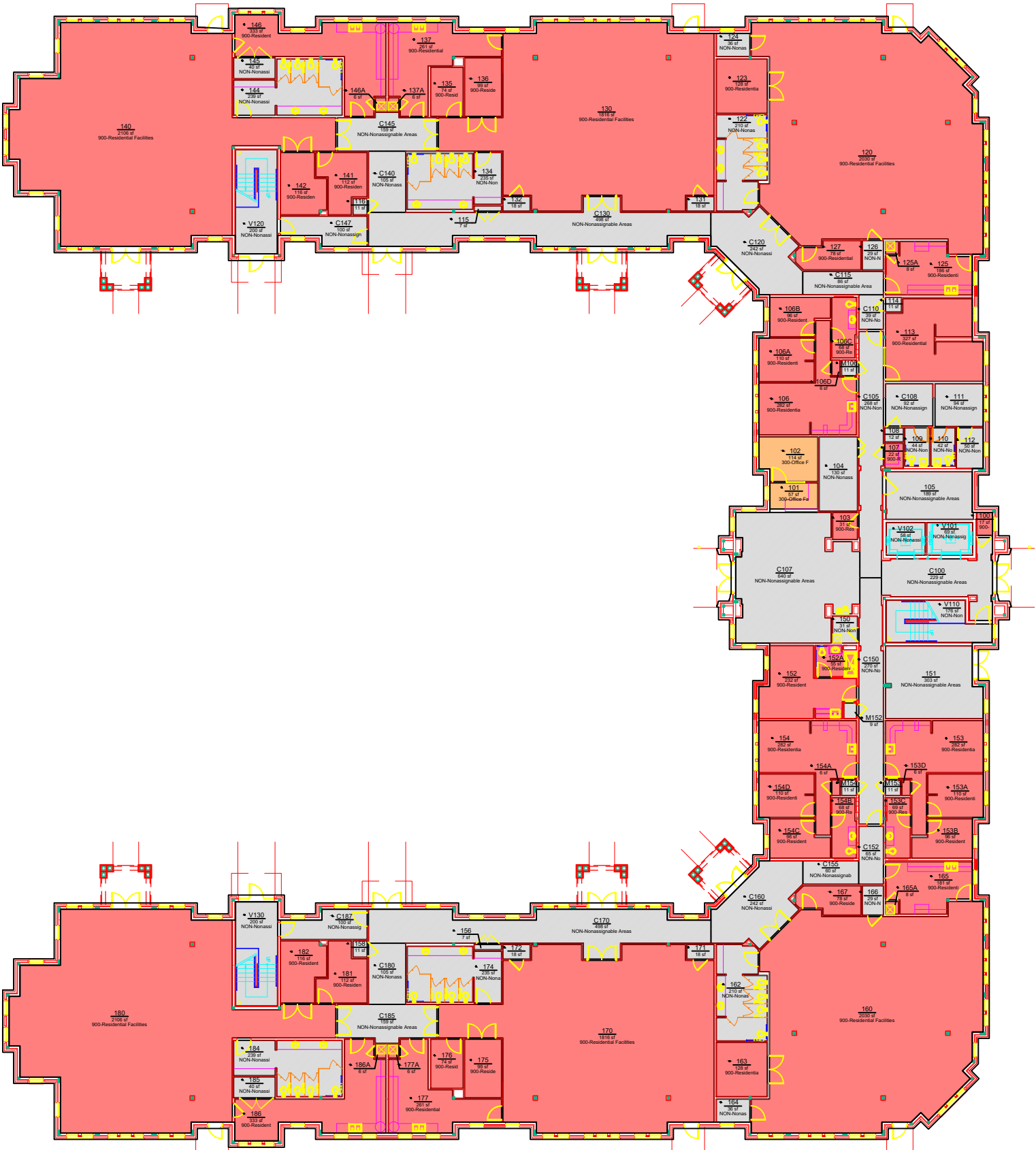

ROOM	ROOM CATEGORY
100	900-Residential Facilities
101	300-Office Facilities
102	300-Office Facilities
103	900-Residential Facilities
104	NON-Nonassignable Areas
106	900-Residential Facilities
106A	900-Residential Facilities
106B	900-Residential Facilities
106C	900-Residential Facilities
106D	900-Residential Facilities
107	900-Residential Facilities
108	NON-Nonassignable Areas
109	NON-Nonassignable Areas
110	NON-Nonassignable Areas
111	NON-Nonassignable Areas
112	NON-Nonassignable Areas
113	900-Residential Facilities
114	NON-Nonassignable Areas
115	NON-Nonassignable Areas
116	NON-Nonassignable Areas
122	NON-Nonassignable Areas
123	900-Residential Facilities
124	NON-Nonassignable Areas
125	900-Residential Facilities
125A	900-Residential Facilities
126	NON-Nonassignable Areas
127	900-Residential Facilities
131	NON-Nonassignable Areas
132	NON-Nonassignable Areas
134	NON-Nonassignable Areas
135	900-Residential Facilities
136	900-Residential Facilities
137	900-Residential Facilities
137A	900-Residential Facilities
141	900-Residential Facilities
142	900-Residential Facilities
144	NON-Nonassignable Areas
145	NON-Nonassignable Areas
146	900-Residential Facilities
146A	900-Residential Facilities
150	NON-Nonassignable Areas
152	900-Residential Facilities
152A	900-Residential Facilities
153	900-Residential Facilities
153A	900-Residential Facilities
153B	900-Residential Facilities
153C	900-Residential Facilities
153D	900-Residential Facilities
154	900-Residential Facilities
154A	900-Residential Facilities
154B	900-Residential Facilities
154C	900-Residential Facilities
154D	900-Residential Facilities
156	NON-Nonassignable Areas
158	NON-Nonassignable Areas
162	NON-Nonassignable Areas
163	900-Residential Facilities
164	NON-Nonassignable Areas
165	900-Residential Facilities
165A	900-Residential Facilities
166	NON-Nonassignable Areas
167	900-Residential Facilities
171	NON-Nonassignable Areas
172	NON-Nonassignable Areas
174	NON-Nonassignable Areas
175	900-Residential Facilities
176	900-Residential Facilities
177	900-Residential Facilities
177A	900-Residential Facilities
181	900-Residential Facilities
182	900-Residential Facilities
184	NON-Nonassignable Areas
185	NON-Nonassignable Areas
186	900-Residential Facilities
186A	900-Residential Facilities
C105	NON-Nonassignable Areas
C108	NON-Nonassignable Areas
C110	NON-Nonassignable Areas
C115	NON-Nonassignable Areas
C120	NON-Nonassignable Areas
C140	NON-Nonassignable Areas
C147	NON-Nonassignable Areas
C150	NON-Nonassignable Areas
C152	NON-Nonassignable Areas
C155	NON-Nonassignable Areas
C160	NON-Nonassignable Areas
C180	NON-Nonassignable Areas
C187	NON-Nonassignable Areas
M106	NON-Nonassignable Areas
M152	NON-Nonassignable Areas
M153	NON-Nonassignable Areas
M154	NON-Nonassignable Areas
V101	NON-Nonassignable Areas
V102	NON-Nonassignable Areas
V110	NON-Nonassignable Areas
V120	NON-Nonassignable Areas
V130	NON-Nonassignable Areas
End of chart	



Office of the
University Architect
Facilities Management
1161 West Samford Ave., Building 1
Auburn, AL 36849

ROOM CATEGORY
Oak Residence Hall
LEVEL: 01

Building No.: AA_R0401
File Name: AA_R0401_01
Last Export: 08/13/2015
Report Created By: Ellen Doyle
Report Date: 09/10/2018