

ROOM CATEGORY			
	AREA	QTY	
300-Office Facilities	262	2	
900-Residential Facilities	19,137	162	
Non-Assignable Areas	4,427	43	
TOTAL:	23,826	207	
Floor Gross:	26,896		

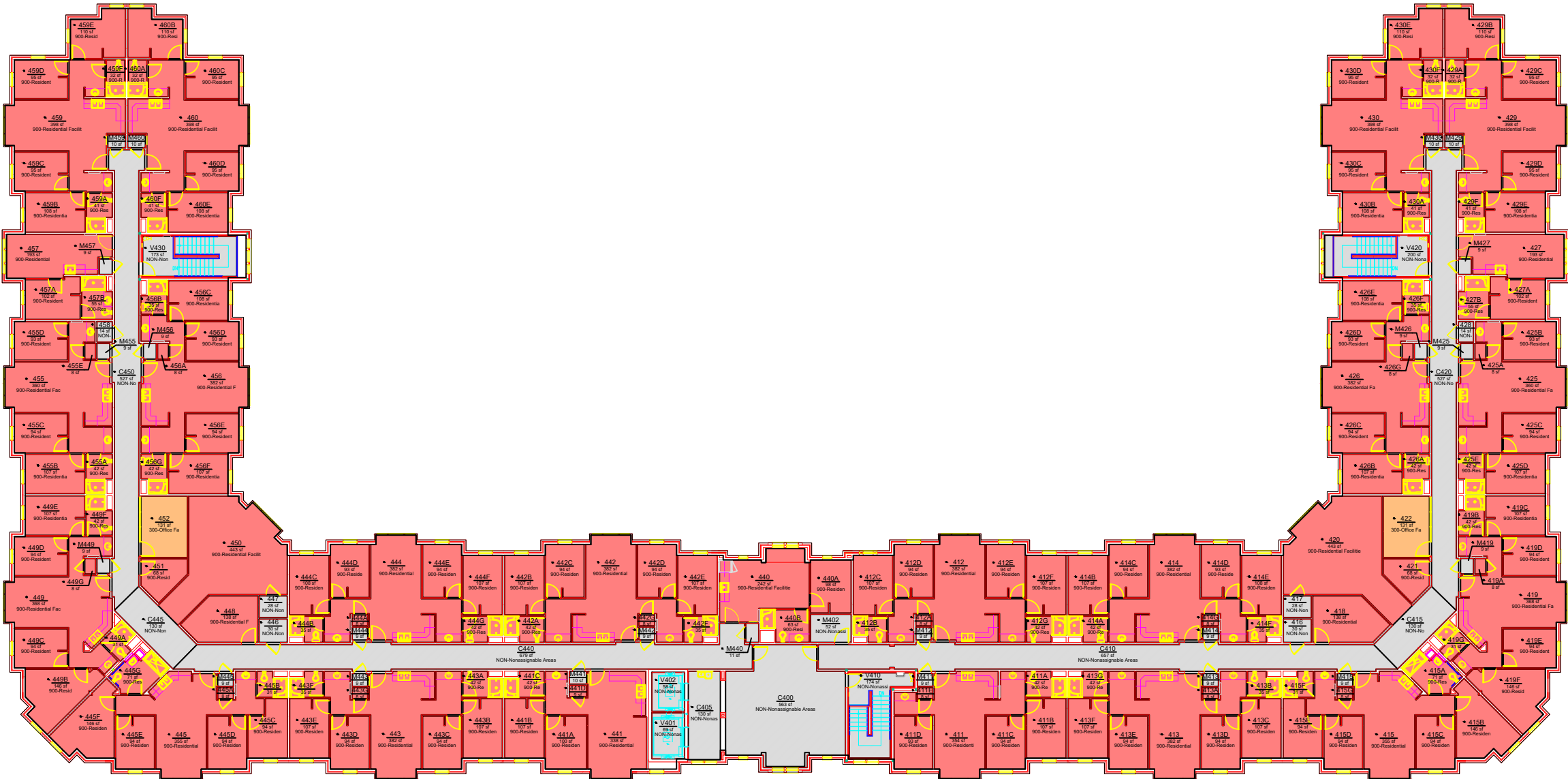

ROOM	ROOM CATEGORY	ROOM	ROOM CATEGORY	ROOM	ROOM CATEGORY	ROOM	ROOM CATEGORY	ROOM	ROOM CATEGORY	ROOM	ROOM CATEGORY
411	900-Residential Facilities	415A	900-Residential Facilities	426D	900-Residential Facilities	442A	900-Residential Facilities	458	NON-Nonassignable Areas	M430	NON-Nonassignable Areas
411A	900-Residential Facilities	415B	900-Residential Facilities	426E	900-Residential Facilities	442B	900-Residential Facilities	459	900-Residential Facilities	V440	NON-Nonassignable Areas
411B	900-Residential Facilities	415C	900-Residential Facilities	426F	900-Residential Facilities	442C	900-Residential Facilities	459A	900-Residential Facilities	M441	NON-Nonassignable Areas
411C	900-Residential Facilities	415D	900-Residential Facilities	426G	900-Residential Facilities	442D	900-Residential Facilities	459B	900-Residential Facilities	M442	NON-Nonassignable Areas
411D	900-Residential Facilities	415E	900-Residential Facilities	427	900-Residential Facilities	442E	900-Residential Facilities	459C	900-Residential Facilities	M443	NON-Nonassignable Areas
411E	900-Residential Facilities	415F	900-Residential Facilities	427A	900-Residential Facilities	442F	900-Residential Facilities	459D	900-Residential Facilities	M444	NON-Nonassignable Areas
412	900-Residential Facilities	415G	900-Residential Facilities	427B	900-Residential Facilities	442G	900-Residential Facilities	459E	900-Residential Facilities	M445	NON-Nonassignable Areas
412A	900-Residential Facilities	416	NON-Nonassignable Areas	427C	900-Residential Facilities	442H	900-Residential Facilities	459F	900-Residential Facilities	M446	NON-Nonassignable Areas
412B	900-Residential Facilities	417	NON-Nonassignable Areas	427D	900-Residential Facilities	442I	900-Residential Facilities	460	900-Residential Facilities	M447	NON-Nonassignable Areas
412C	900-Residential Facilities	418	900-Residential Facilities	427E	900-Residential Facilities	442J	900-Residential Facilities	460A	900-Residential Facilities	M448	NON-Nonassignable Areas
412D	900-Residential Facilities	419	900-Residential Facilities	427F	900-Residential Facilities	442K	900-Residential Facilities	460B	900-Residential Facilities	M449	NON-Nonassignable Areas
412E	900-Residential Facilities	419A	900-Residential Facilities	427G	900-Residential Facilities	442L	900-Residential Facilities	460C	900-Residential Facilities	M450	NON-Nonassignable Areas
412F	900-Residential Facilities	419B	900-Residential Facilities	427H	900-Residential Facilities	442M	900-Residential Facilities	460D	900-Residential Facilities	M451	NON-Nonassignable Areas
412G	900-Residential Facilities	419C	900-Residential Facilities	427I	900-Residential Facilities	442N	900-Residential Facilities	460E	900-Residential Facilities	M452	NON-Nonassignable Areas
413	900-Residential Facilities	419D	900-Residential Facilities	427J	900-Residential Facilities	442O	900-Residential Facilities	460F	900-Residential Facilities	V401	NON-Nonassignable Areas
413A	900-Residential Facilities	419E	900-Residential Facilities	427K	900-Residential Facilities	442P	900-Residential Facilities	460G	900-Residential Facilities	V402	NON-Nonassignable Areas
413B	900-Residential Facilities	419F	900-Residential Facilities	427L	900-Residential Facilities	442Q	900-Residential Facilities	460H	900-Residential Facilities	V410	NON-Nonassignable Areas
413C	900-Residential Facilities	419G	900-Residential Facilities	427M	900-Residential Facilities	442R	900-Residential Facilities	460I	900-Residential Facilities	V420	NON-Nonassignable Areas
413D	900-Residential Facilities	420	900-Residential Facilities	427N	900-Residential Facilities	442S	900-Residential Facilities	460J	900-Residential Facilities	V430	NON-Nonassignable Areas
413E	900-Residential Facilities	421	900-Residential Facilities	427O	900-Residential Facilities	442T	900-Residential Facilities	460K	900-Residential Facilities		
413F	900-Residential Facilities	422	300-Office Facilities	427P	900-Residential Facilities	442U	900-Residential Facilities	460L	900-Residential Facilities		
413G	900-Residential Facilities	423	900-Residential Facilities	427Q	900-Residential Facilities	442V	900-Residential Facilities	460M	900-Residential Facilities		
414	900-Residential Facilities	423A	900-Residential Facilities	427R	900-Residential Facilities	442W	900-Residential Facilities	460N	900-Residential Facilities		
414A	900-Residential Facilities	423B	900-Residential Facilities	427S	900-Residential Facilities	442X	900-Residential Facilities	460O	900-Residential Facilities		
414B	900-Residential Facilities	423C	900-Residential Facilities	427T	900-Residential Facilities	442Y	900-Residential Facilities	460P	900-Residential Facilities		
414C	900-Residential Facilities	423D	900-Residential Facilities	427U	900-Residential Facilities	442Z	900-Residential Facilities	460Q	900-Residential Facilities		
414D	900-Residential Facilities	423E	900-Residential Facilities	427V	900-Residential Facilities	443	900-Residential Facilities	460R	900-Residential Facilities		
414E	900-Residential Facilities	423F	900-Residential Facilities	427W	900-Residential Facilities	443A	900-Residential Facilities	460S	900-Residential Facilities		
414F	900-Residential Facilities	423G	900-Residential Facilities	427X	900-Residential Facilities	443B	900-Residential Facilities	460T	900-Residential Facilities		
414G	900-Residential Facilities	423H	900-Residential Facilities	427Y	900-Residential Facilities	443C	900-Residential Facilities	460U	900-Residential Facilities		
415	900-Residential Facilities	423I	900-Residential Facilities	427Z	900-Residential Facilities	443D	900-Residential Facilities	460V	900-Residential Facilities		

ROOM CATEGORY

Magnolia Residence Hall

LEVEL: 04

Building No.: AA_R0502

File Name: AA_R0502_04

Last Export: 08/13/2015

Report Created By:Ellen Doyle

Report Date: 09/10/2018



Office of the
University Architect
Facilities Management
1161 West Samford Ave., Building 1
Auburn, AL 36849