

ROOM CATEGORY		
	AREA	QTY
100-Classroom Facilities	6,699	6
200-Laboratory Facilities	108	1
300-Office Facilities	545	1
400-Study Facilities	4,739	12
Non-Assignable Areas	7,120	19
TOTAL:	19,211	39
Floor Gross:	21,816	

2014	400-Study Facilities
2014	400-Study Facilities
2016	100-Classroom Facilities
2028	NON-Nonassignable Areas
2034	400-Study Facilities
2035	400-Study Facilities
2036	NON-Nonassignable Areas
2037	NON-Nonassignable Areas
2038	400-Study Facilities
2039	400-Study Facilities
2041	400-Study Facilities
2042	NON-Nonassignable Areas
2043	NON-Nonassignable Areas
2045	NON-Nonassignable Areas
2047A	100-Classroom Facilities
2063	200-Laboratory Facilities
C2016	NON-Nonassignable Areas
C2020	NON-Nonassignable Areas
C2025	NON-Nonassignable Areas
V2001	NON-Nonassignable Areas
V2002	NON-Nonassignable Areas
V2003	NON-Nonassignable Areas
V2006	NON-Nonassignable Areas
V2007	NON-Nonassignable Areas
X2001	NON-Nonassignable Areas

End of chart

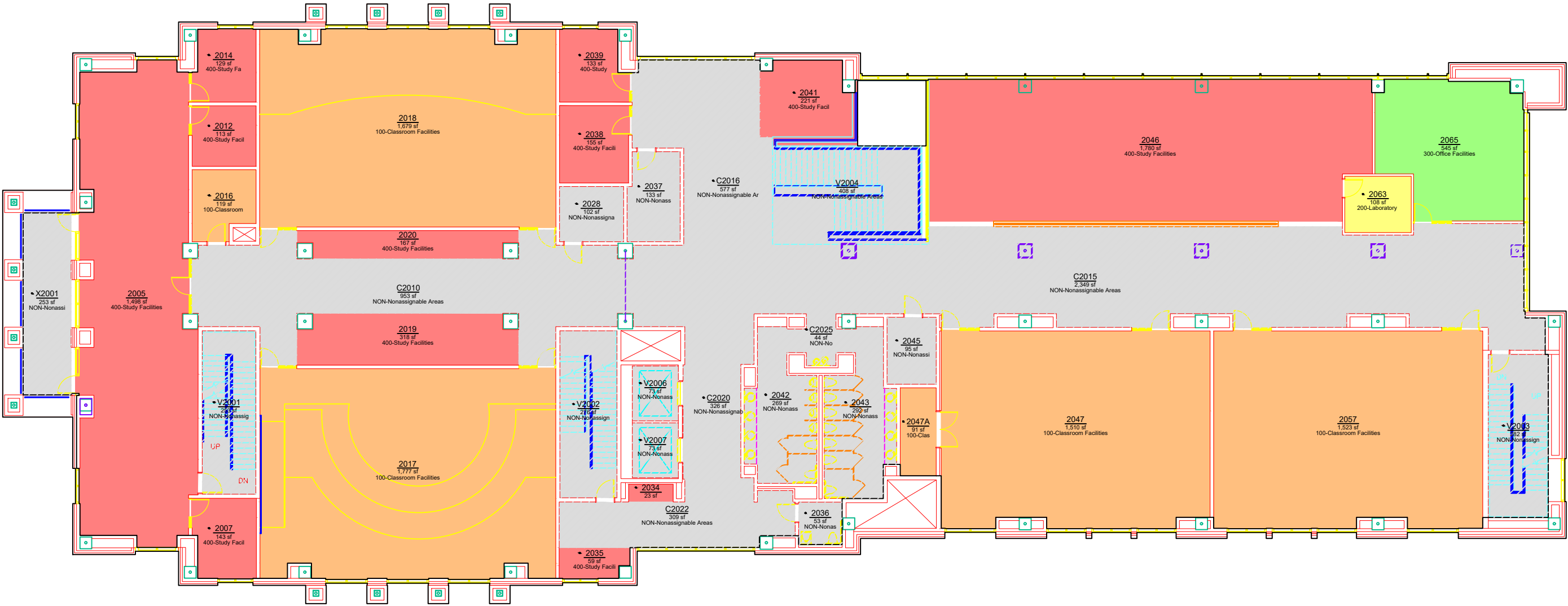

Office of the
University Architect
Facilities Management
1161 West Samford Ave., Building 1
Auburn, AL 36849

ROOM CATEGORY
Horton Hardgrave Hall
Level: 02

Building No.: AA_T0203
File Name: AA_T0203_02
Last Export: 06/29/2021
Report Created By: Ellen Doyle
Report Date: 04/18/2022