

ROOM CATEGORY		
	AREA	QTY
300-Office Facilities	10	1
600-General Use Facilities	1,175	4
900-Residential Facilities	3,758	52
Non-Assignable Areas	2,999	19
TOTAL:	7,942	76
Floor Gross:	9,189	

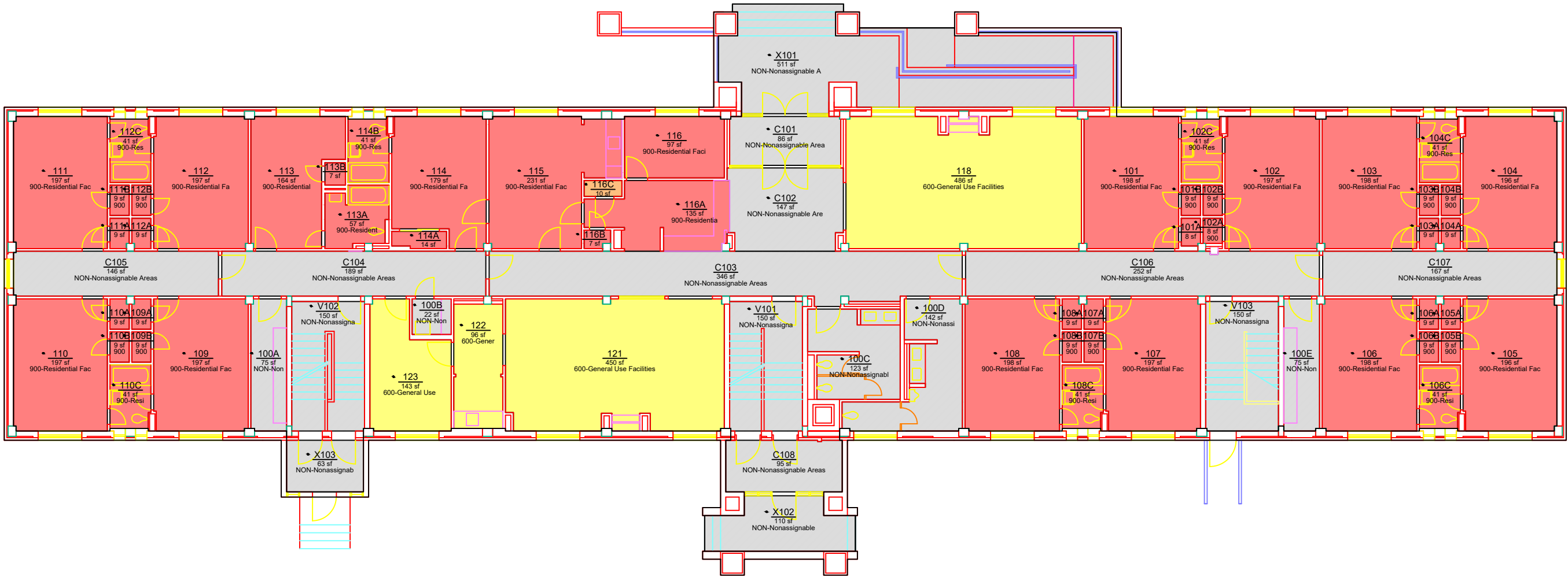

ROOM	ROOM CATEGORY	ROOM	ROOM CATEGORY	ROOM	ROOM CATEGORY	ROOM	ROOM CATEGORY
100A	NON-Nonassignable Areas	105A	900-Residential Facilities	111	900-Residential Facilities	C101	NON-Nonassignable Areas
100B	NON-Nonassignable Areas	105B	900-Residential Facilities	111A	900-Residential Facilities	C102	NON-Nonassignable Areas
100C	NON-Nonassignable Areas	106	900-Residential Facilities	111B	900-Residential Facilities	V101	NON-Nonassignable Areas
100D	NON-Nonassignable Areas	106A	900-Residential Facilities	112	900-Residential Facilities	V102	NON-Nonassignable Areas
100E	NON-Nonassignable Areas	106B	900-Residential Facilities	112A	900-Residential Facilities	V103	NON-Nonassignable Areas
101	900-Residential Facilities	106C	900-Residential Facilities	112B	900-Residential Facilities	X101	NON-Nonassignable Areas
101A	900-Residential Facilities	107	900-Residential Facilities	112C	900-Residential Facilities	X102	NON-Nonassignable Areas
101B	900-Residential Facilities	107A	900-Residential Facilities	113	900-Residential Facilities	X103	NON-Nonassignable Areas
102	900-Residential Facilities	107B	900-Residential Facilities	113A	900-Residential Facilities		
102A	900-Residential Facilities	108	900-Residential Facilities	113B	900-Residential Facilities		
102B	900-Residential Facilities	108A	900-Residential Facilities	114	900-Residential Facilities		
102C	900-Residential Facilities	108B	900-Residential Facilities	114A	900-Residential Facilities		
103	900-Residential Facilities	108C	900-Residential Facilities	114B	900-Residential Facilities		
103A	900-Residential Facilities	109	900-Residential Facilities	115	900-Residential Facilities		
103B	900-Residential Facilities	109A	900-Residential Facilities	116	900-Residential Facilities		
104	900-Residential Facilities	109B	900-Residential Facilities	116A	900-Residential Facilities		
104A	900-Residential Facilities	110	900-Residential Facilities	116B	900-Residential Facilities		
104B	900-Residential Facilities	110A	900-Residential Facilities	116C	300-Office Facilities		
104C	900-Residential Facilities	110B	900-Residential Facilities	122	600-General Use Facilities		
105	900-Residential Facilities	110C	900-Residential Facilities	123	600-General Use Facilities		



Office of the  
University Architect  
Facilities Management  
1161 West Samford Ave., Building 1  
Auburn, AL 36849

ROOM CATEGORY  
Dobbs Residence Hall  
Level: 01

Building No.: AA_V0803
File Name: AA_V0803_01
Last Export: 08/13/2015
Report Created By: Ellen Doyle
Report Date: 09/13/2018