

ROOM CATEGORY			
		AREA	QTY
<div></div>	600-General Use Facilities	1,181	4
<div></div>	900-Residential Facilities	3,745	53
<div></div>	Non-Assignable Areas	2,593	18
TOTAL:		7,519	75
Floor Gross:		8,694	

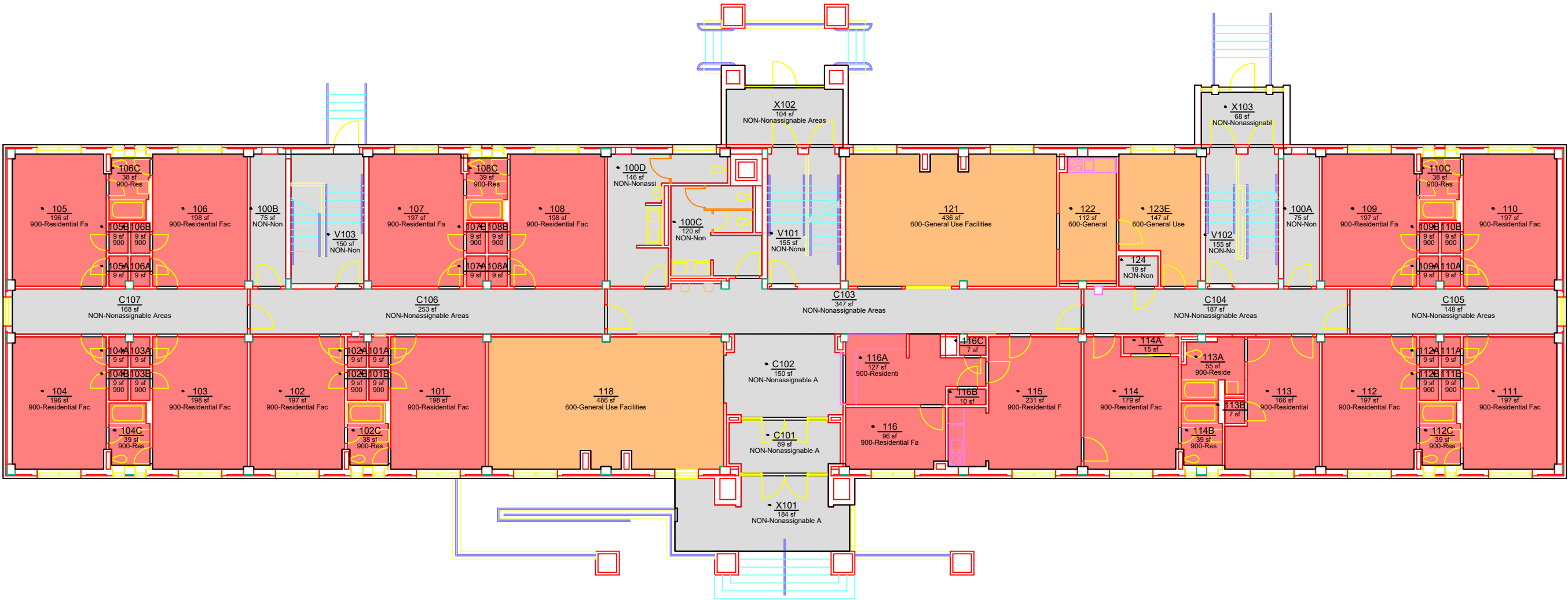

ROOM	ROOM CATEGORY	ROOM	ROOM CATEGORY	ROOM	ROOM CATEGORY	ROOM	ROOM CATEGORY
100A	NON-Nonassignable Areas	105B	900-Residential Facilities	111A	900-Residential Facilities	C101	NON-Nonassignable Areas
100B	NON-Nonassignable Areas	105C	900-Residential Facilities	111B	900-Residential Facilities	C102	NON-Nonassignable Areas
100C	NON-Nonassignable Areas	105D	900-Residential Facilities	112	900-Residential Facilities	V101	NON-Nonassignable Areas
100D	NON-Nonassignable Areas	105E	900-Residential Facilities	112A	900-Residential Facilities	V102	NON-Nonassignable Areas
101	900-Residential Facilities	105F	900-Residential Facilities	112B	900-Residential Facilities	V103	NON-Nonassignable Areas
101A	900-Residential Facilities	105G	900-Residential Facilities	112C	900-Residential Facilities	X101	NON-Nonassignable Areas
101B	900-Residential Facilities	105H	900-Residential Facilities	113	900-Residential Facilities	X103	NON-Nonassignable Areas
102	900-Residential Facilities	105I	900-Residential Facilities	113A	900-Residential Facilities		
102A	900-Residential Facilities	105J	900-Residential Facilities	113B	900-Residential Facilities		
102B	900-Residential Facilities	105K	900-Residential Facilities	114	900-Residential Facilities		
102C	900-Residential Facilities	105L	900-Residential Facilities	114A	900-Residential Facilities		
103	900-Residential Facilities	105M	900-Residential Facilities	114B	900-Residential Facilities		
103A	900-Residential Facilities	105N	900-Residential Facilities	115	900-Residential Facilities		
103B	900-Residential Facilities	105O	900-Residential Facilities	116	900-Residential Facilities		
104	900-Residential Facilities	105P	900-Residential Facilities	116A	900-Residential Facilities		
104A	900-Residential Facilities	105Q	900-Residential Facilities	116B	900-Residential Facilities		
104B	900-Residential Facilities	105R	900-Residential Facilities	116C	900-Residential Facilities		
104C	900-Residential Facilities	105S	900-Residential Facilities	122	600-General Use Facilities		
105	900-Residential Facilities	105T	900-Residential Facilities	123E	600-General Use Facilities		
105A	900-Residential Facilities	105U	900-Residential Facilities	124	NON-Nonassignable Areas		



Office of the
University Architect
Facilities Management
1161 West Samford Ave., Building 1
Auburn, AL 36849

ROOM CATEGORY
Graves Residence Hall
Level: 01

Building No.:	AA_V0901
File Name:	AA_V0901_01
Last Export:	08/13/2015
Report Created By:	Ellen Doyle
Report Date:	09/13/2018