

ROOM CATEGORY			
	AREA	QTY	
600-General Use Facilities	1,036	2	
900-Residential Facilities	3,667	39	
Non-Assignable Areas	3,993	22	
TOTAL:	8,696	63	
Floor Gross:	10,047		

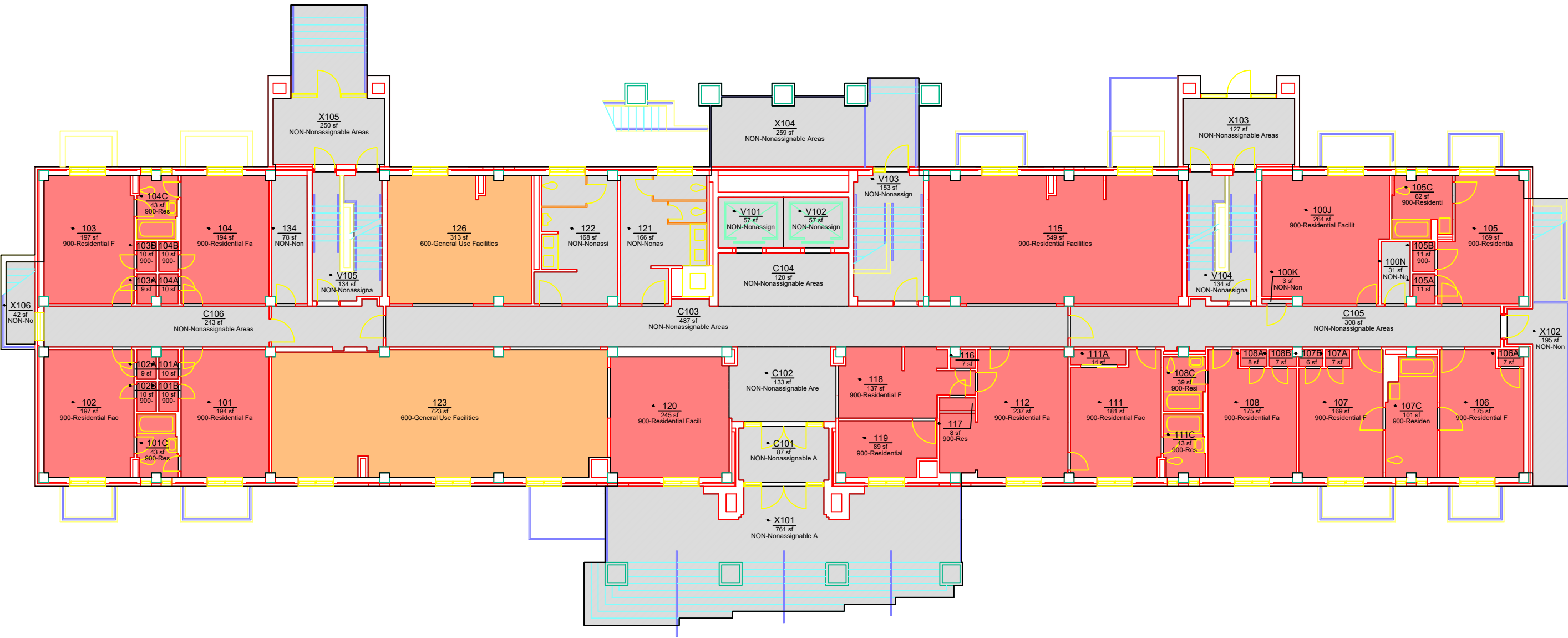

ROOM	ROOM CATEGORY	ROOM	ROOM CATEGORY	ROOM	ROOM CATEGORY
100J	900-Residential Facilities	105A	900-Residential Facilities	117	900-Residential Facilities
100K	NON-Nonassignable Areas	105B	900-Residential Facilities	118	900-Residential Facilities
100N	NON-Nonassignable Areas	105C	900-Residential Facilities	119	900-Residential Facilities
101	900-Residential Facilities	106	900-Residential Facilities	120	900-Residential Facilities
101A	900-Residential Facilities	106A	900-Residential Facilities	121	NON-Nonassignable Areas
101B	900-Residential Facilities	107	900-Residential Facilities	122	NON-Nonassignable Areas
101C	900-Residential Facilities	107A	900-Residential Facilities	134	NON-Nonassignable Areas
102	900-Residential Facilities	107B	900-Residential Facilities	C101	NON-Nonassignable Areas
102A	900-Residential Facilities	107C	900-Residential Facilities	C102	NON-Nonassignable Areas
102B	900-Residential Facilities	108	900-Residential Facilities	V101	NON-Nonassignable Areas
103	900-Residential Facilities	108A	900-Residential Facilities	V102	NON-Nonassignable Areas
103A	900-Residential Facilities	108B	900-Residential Facilities	V103	NON-Nonassignable Areas
103B	900-Residential Facilities	108C	900-Residential Facilities	V104	NON-Nonassignable Areas
104	900-Residential Facilities	111	900-Residential Facilities	V105	NON-Nonassignable Areas
104A	900-Residential Facilities	111A	900-Residential Facilities	X101	NON-Nonassignable Areas
104B	900-Residential Facilities	111C	900-Residential Facilities	X102	NON-Nonassignable Areas
104C	900-Residential Facilities	112	900-Residential Facilities	X106	NON-Nonassignable Areas
105	900-Residential Facilities	116	900-Residential Facilities		End of chart



Office of the  
University Architect  
Facilities Management  
1161 West Samford Ave., Building 1  
Auburn, AL 36849

ROOM CATEGORY  
Sasnett Residence Hall  
Level: 01

Building No.: AA_V0904
File Name: AA_V0904_01
Last Export: 08/13/2015
Report Created By: Ellen Doyle
Report Date: 09/13/2018