

ROOM CATEGORY			
	AREA	QTY	
<div></div> 300-Office Facilities	344	2	
<div></div> 900-Residential Facilities	4,916	73	
<div></div> Non-Assignable Areas	1,804	14	
TOTAL:	7,064	89	
Floor Gross:	8,311		

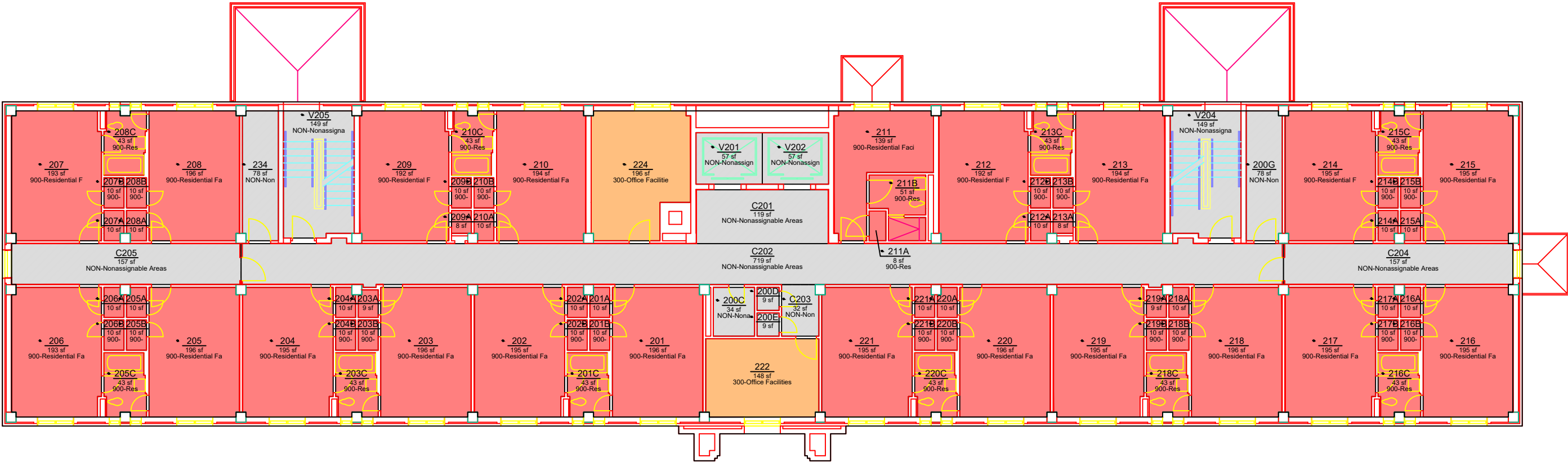

ROOM	ROOM CATEGORY	ROOM	ROOM CATEGORY	ROOM	ROOM CATEGORY
200C	NON-Nonassignable Areas	208B	900-Residential Facilities	217	900-Residential Facilities
200D	NON-Nonassignable Areas	208C	900-Residential Facilities	217A	900-Residential Facilities
200E	NON-Nonassignable Areas	209	900-Residential Facilities	217B	900-Residential Facilities
200G	NON-Nonassignable Areas	209A	900-Residential Facilities	218	900-Residential Facilities
201	900-Residential Facilities	209B	900-Residential Facilities	218A	900-Residential Facilities
201A	900-Residential Facilities	210	900-Residential Facilities	218B	900-Residential Facilities
201B	900-Residential Facilities	210A	900-Residential Facilities	218C	900-Residential Facilities
201C	900-Residential Facilities	210B	900-Residential Facilities	219	900-Residential Facilities
202	900-Residential Facilities	210C	900-Residential Facilities	219A	900-Residential Facilities
202A	900-Residential Facilities	211	900-Residential Facilities	219B	900-Residential Facilities
202B	900-Residential Facilities	211A	900-Residential Facilities	220	900-Residential Facilities
203	900-Residential Facilities	211B	900-Residential Facilities	220A	900-Residential Facilities
203A	900-Residential Facilities	212	900-Residential Facilities	220B	900-Residential Facilities
203B	900-Residential Facilities	212A	900-Residential Facilities	220C	900-Residential Facilities
203C	900-Residential Facilities	212B	900-Residential Facilities	221	900-Residential Facilities
204	900-Residential Facilities	213	900-Residential Facilities	221A	900-Residential Facilities
204A	900-Residential Facilities	213A	900-Residential Facilities	221B	900-Residential Facilities
204B	900-Residential Facilities	213B	900-Residential Facilities	224	300-Office Facilities
205	900-Residential Facilities	213C	900-Residential Facilities	234	NON-Nonassignable Areas
205A	900-Residential Facilities	214	900-Residential Facilities	C203	NON-Nonassignable Areas
205B	900-Residential Facilities	214A	900-Residential Facilities	V201	NON-Nonassignable Areas
205C	900-Residential Facilities	214B	900-Residential Facilities	V202	NON-Nonassignable Areas
206	900-Residential Facilities	215	900-Residential Facilities	V204	NON-Nonassignable Areas
206A	900-Residential Facilities	215A	900-Residential Facilities	V205	NON-Nonassignable Areas
206B	900-Residential Facilities	215B	900-Residential Facilities		
207	900-Residential Facilities	215C	900-Residential Facilities		
207A	900-Residential Facilities	216	900-Residential Facilities		
207B	900-Residential Facilities	216A	900-Residential Facilities		
208	900-Residential Facilities	216B	900-Residential Facilities		
208A	900-Residential Facilities	216C	900-Residential Facilities		



Office of the
University Architect
Facilities Management
1161 West Samford Ave., Building 1
Auburn, AL 36849

ROOM CATEGORY
Sasnett Residence Hall
Level: 02

Building No.: AA_V0904
File Name: AA_V0904_02
Last Export: 08/13/2015
Report Created By: Ellen Doyle
Report Date: 09/13/2018