

ROOM CATEGORY			
	AREA	QTY	
<div></div> 300-Office Facilities	344	2	
<div></div> 900-Residential Facilities	4,753	71	
<div></div> Non-Assignable Areas	1,949	14	
TOTAL:	7,046	87	
Floor Gross:	8,267		

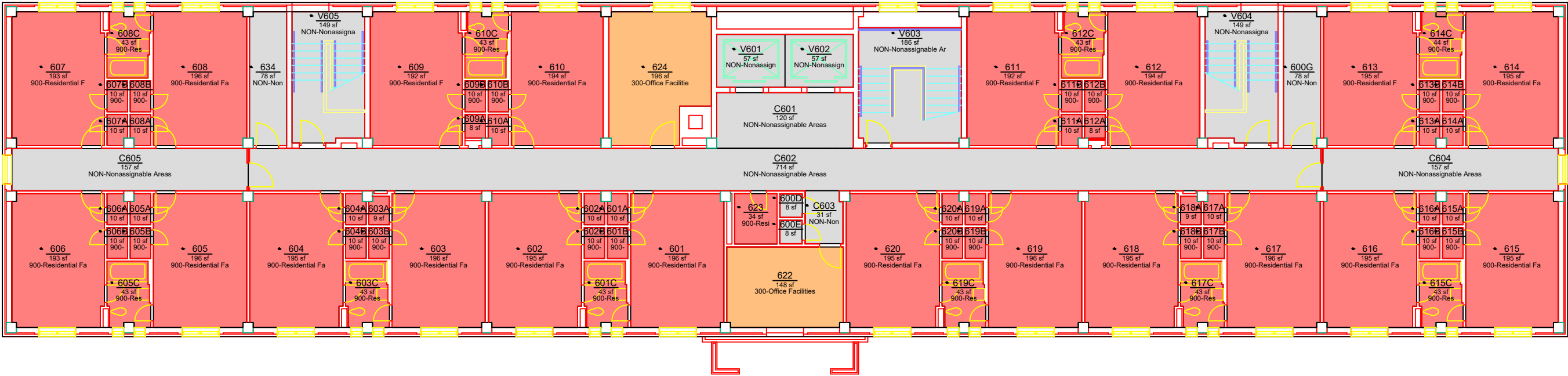

ROOM	ROOM CATEGORY	ROOM	ROOM CATEGORY	ROOM	ROOM CATEGORY
600D	NON-Nonassignable Areas	609A	900-Residential Facilities	618A	900-Residential Facilities
600E	NON-Nonassignable Areas	609B	900-Residential Facilities	618B	900-Residential Facilities
600G	NON-Nonassignable Areas	610	900-Residential Facilities	619	900-Residential Facilities
601	900-Residential Facilities	610A	900-Residential Facilities	619A	900-Residential Facilities
601A	900-Residential Facilities	610B	900-Residential Facilities	619B	900-Residential Facilities
601B	900-Residential Facilities	610C	900-Residential Facilities	619C	900-Residential Facilities
601C	900-Residential Facilities	611	900-Residential Facilities	620	900-Residential Facilities
602	900-Residential Facilities	611A	900-Residential Facilities	620A	900-Residential Facilities
602A	900-Residential Facilities	611B	900-Residential Facilities	620B	900-Residential Facilities
602B	900-Residential Facilities	612	900-Residential Facilities	623	900-Residential Facilities
602A	900-Residential Facilities	612A	900-Residential Facilities	624	300-Office Facilities
603	900-Residential Facilities	612B	900-Residential Facilities	634	NON-Nonassignable Areas
603A	900-Residential Facilities	612C	900-Residential Facilities	C603	NON-Nonassignable Areas
603B	900-Residential Facilities	613	900-Residential Facilities	V601	NON-Nonassignable Areas
603C	900-Residential Facilities	613A	900-Residential Facilities	V602	NON-Nonassignable Areas
604	900-Residential Facilities	613B	900-Residential Facilities	V603	NON-Nonassignable Areas
604A	900-Residential Facilities	614	900-Residential Facilities	V604	NON-Nonassignable Areas
604B	900-Residential Facilities	614A	900-Residential Facilities	V605	NON-Nonassignable Areas
605	900-Residential Facilities	614B	900-Residential Facilities		End of chart
605A	900-Residential Facilities	614C	900-Residential Facilities		
605B	900-Residential Facilities	615	900-Residential Facilities		
605C	900-Residential Facilities	615A	900-Residential Facilities		
606	900-Residential Facilities	615B	900-Residential Facilities		