

ROOM CATEGORY			
		AREA	QTY
<div></div>	200-Laboratory Facilities	1,590	18
<div></div>	300-Office Facilities	123	1
<div></div>	Non-Assignable Areas	2,537	5
TOTAL:		4,250	24
Floor Gross:		4,929	

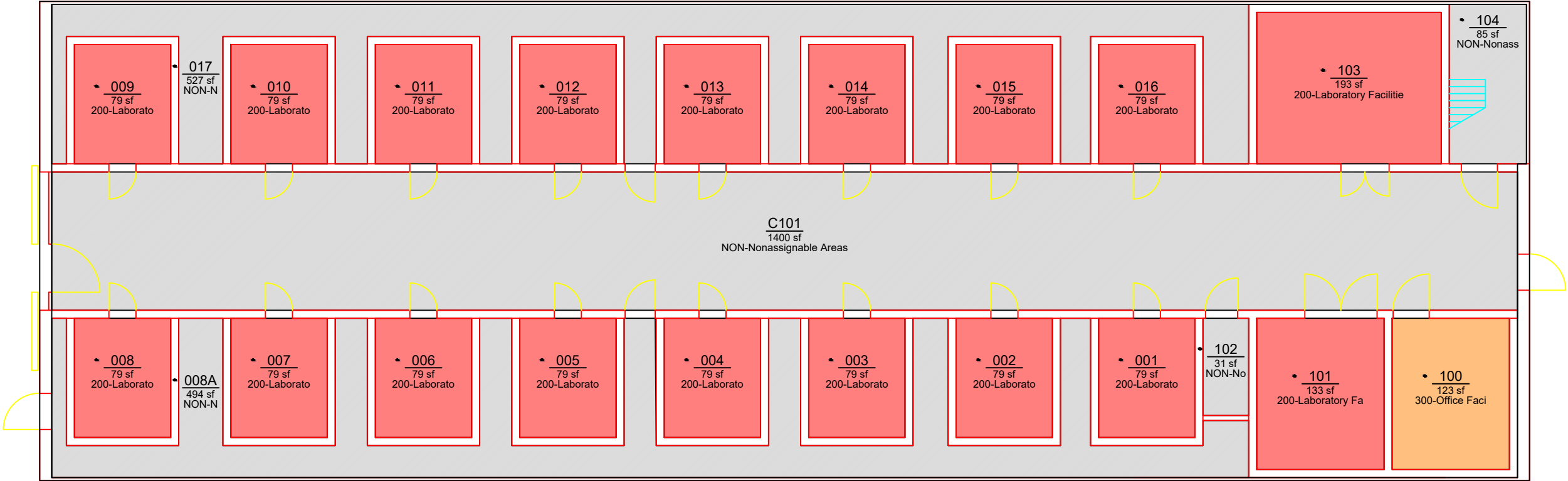

ROOM	ROOM CATEGORY
001	200-Laboratory Facilities
002	200-Laboratory Facilities
003	200-Laboratory Facilities
004	200-Laboratory Facilities
005	200-Laboratory Facilities
006	200-Laboratory Facilities
007	200-Laboratory Facilities
008	200-Laboratory Facilities
008A	NON-Nonassignable Areas
009	200-Laboratory Facilities
010	200-Laboratory Facilities
011	200-Laboratory Facilities
012	200-Laboratory Facilities
013	200-Laboratory Facilities
014	200-Laboratory Facilities
015	200-Laboratory Facilities
016	200-Laboratory Facilities
017	NON-Nonassignable Areas
100	300-Office Facilities
101	200-Laboratory Facilities
102	NON-Nonassignable Areas
103	200-Laboratory Facilities
104	NON-Nonassignable Areas

End of chart



Office of the
University Architect
Facilities Management
1161 West Samford Ave., Building 1
Auburn, AL 36849

ROOM CATEGORY
Laboratory, Avian
Level: 01

Building No.:	AA_V1501
File Name:	AA_V1501_01
Last Export:	06/16/2015
Report Created By:	Ellen Doyle
Report Date:	04/11/2017