

ROOM CATEGORY			
		AREA	QTY
<div></div>	700-Support Facilities	815	1
<div></div>	Non-Assignable Areas	1,700	7
TOTAL:		2,515	8
Floor Gross:		2,974	

ROOM	ROOM CATEGORY
002	NON-Nonassignable Areas
003	NON-Nonassignable Areas
C001	NON-Nonassignable Areas
V002	NON-Nonassignable Areas
V003	NON-Nonassignable Areas
End of chart	

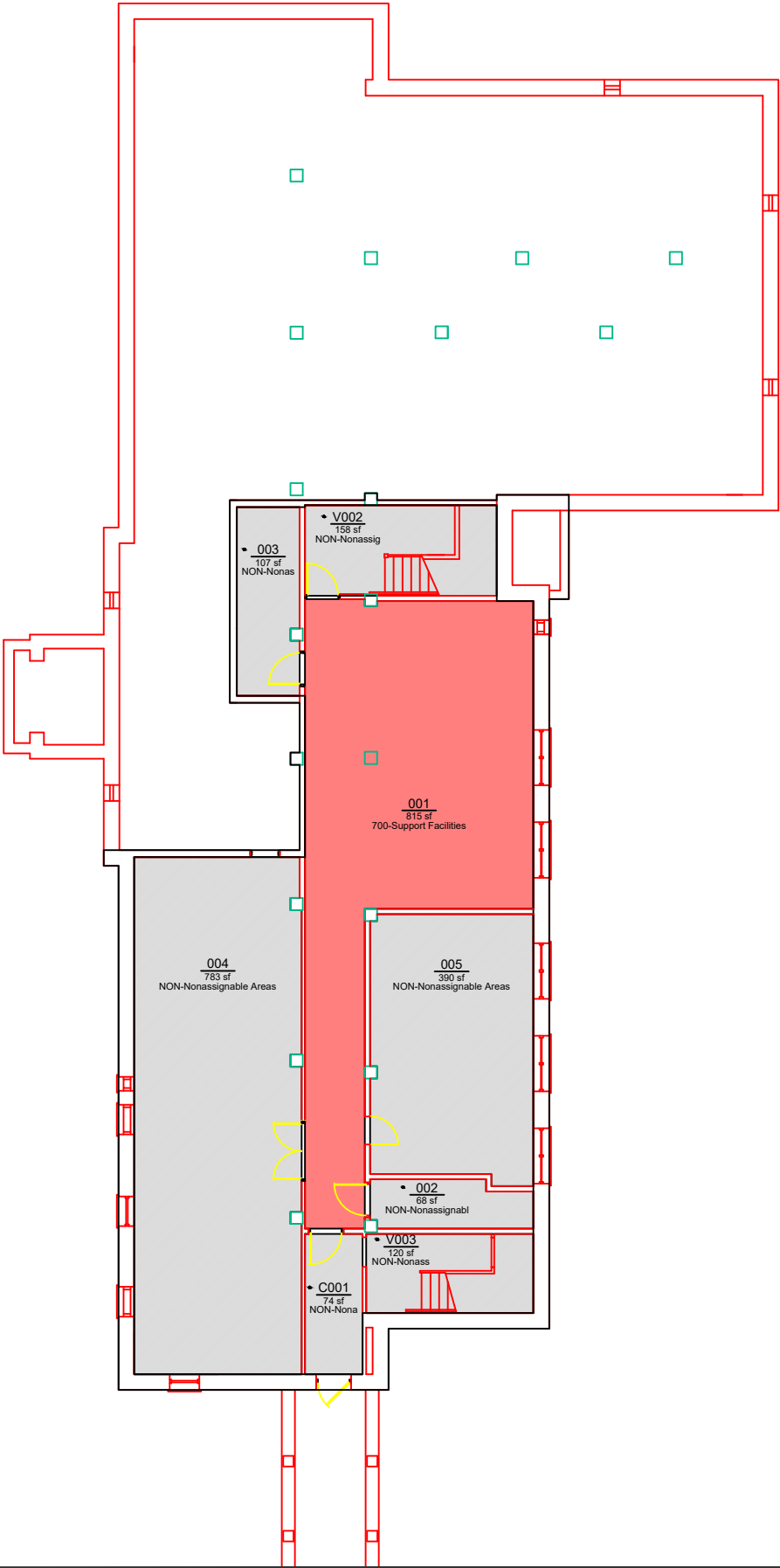

ROOM CATEGORY
Harper Residence Hall
Level: B1