

ROOM CATEGORY		
	AREA	QTY
300-Office Facilities	91	1
900-Residential Facilities	4,336	48
Non-Assignable Areas	1,992	15
TOTAL:	6,419	64
Floor Gross:	7,525	

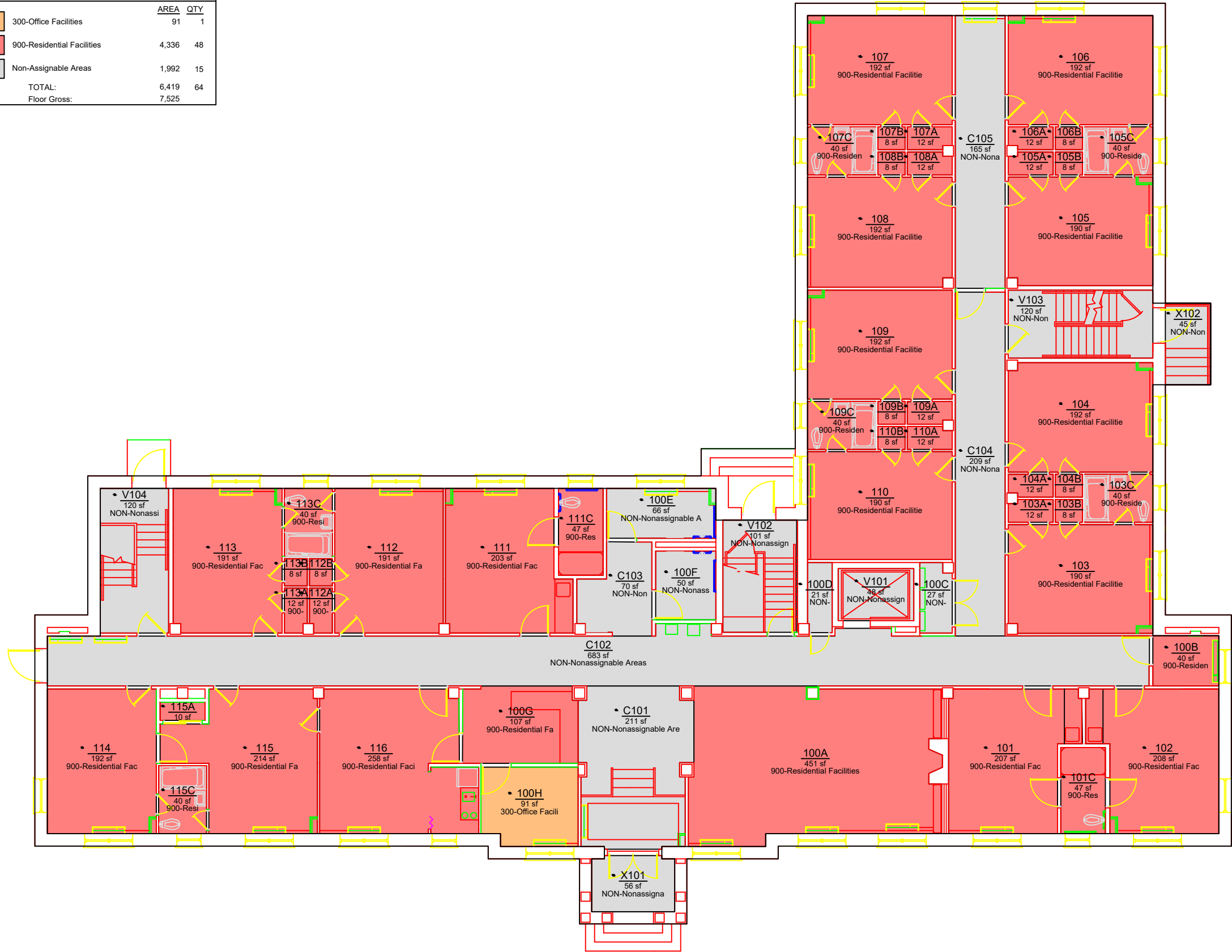

ROOM	ROOM CATEGORY
100B	900-Residential Facilities
100C	NON-Nonassignable Areas
100D	NON-Nonassignable Areas
100E	NON-Nonassignable Areas
100F	NON-Nonassignable Areas
100G	900-Residential Facilities
100H	300-Office Facilities
101	900-Residential Facilities
101C	900-Residential Facilities
102	900-Residential Facilities
103	900-Residential Facilities
103A	900-Residential Facilities
103B	900-Residential Facilities
103C	900-Residential Facilities
104	900-Residential Facilities
104A	900-Residential Facilities
104B	900-Residential Facilities
105	900-Residential Facilities
105A	900-Residential Facilities
105B	900-Residential Facilities
105C	900-Residential Facilities
106	900-Residential Facilities
106A	900-Residential Facilities
106B	900-Residential Facilities
107	900-Residential Facilities
107A	900-Residential Facilities
107B	900-Residential Facilities
107C	900-Residential Facilities
108	900-Residential Facilities
108A	900-Residential Facilities
108B	900-Residential Facilities
109	900-Residential Facilities
109A	900-Residential Facilities
109B	900-Residential Facilities
109C	900-Residential Facilities
110	900-Residential Facilities
110A	900-Residential Facilities
110B	900-Residential Facilities
111	900-Residential Facilities
111C	900-Residential Facilities
112	900-Residential Facilities
112A	900-Residential Facilities
112B	900-Residential Facilities
113	900-Residential Facilities
113A	900-Residential Facilities
113B	900-Residential Facilities
113C	900-Residential Facilities
114	900-Residential Facilities
115	900-Residential Facilities
115A	900-Residential Facilities
115C	900-Residential Facilities
116	900-Residential Facilities
C101	NON-Nonassignable Areas
C103	NON-Nonassignable Areas
C104	NON-Nonassignable Areas
C105	NON-Nonassignable Areas
V101	NON-Nonassignable Areas
V102	NON-Nonassignable Areas
V103	NON-Nonassignable Areas
V104	NON-Nonassignable Areas
X101	NON-Nonassignable Areas
X102	NON-Nonassignable Areas

End of chart