

ROOM CATEGORY		
	AREA	QTY
600-General Use Facilities	774	2
900-Residential Facilities	3,837	50
Non-Assignable Areas	2,220	18
TOTAL:	6,831	70
Floor Gross:	7,953	

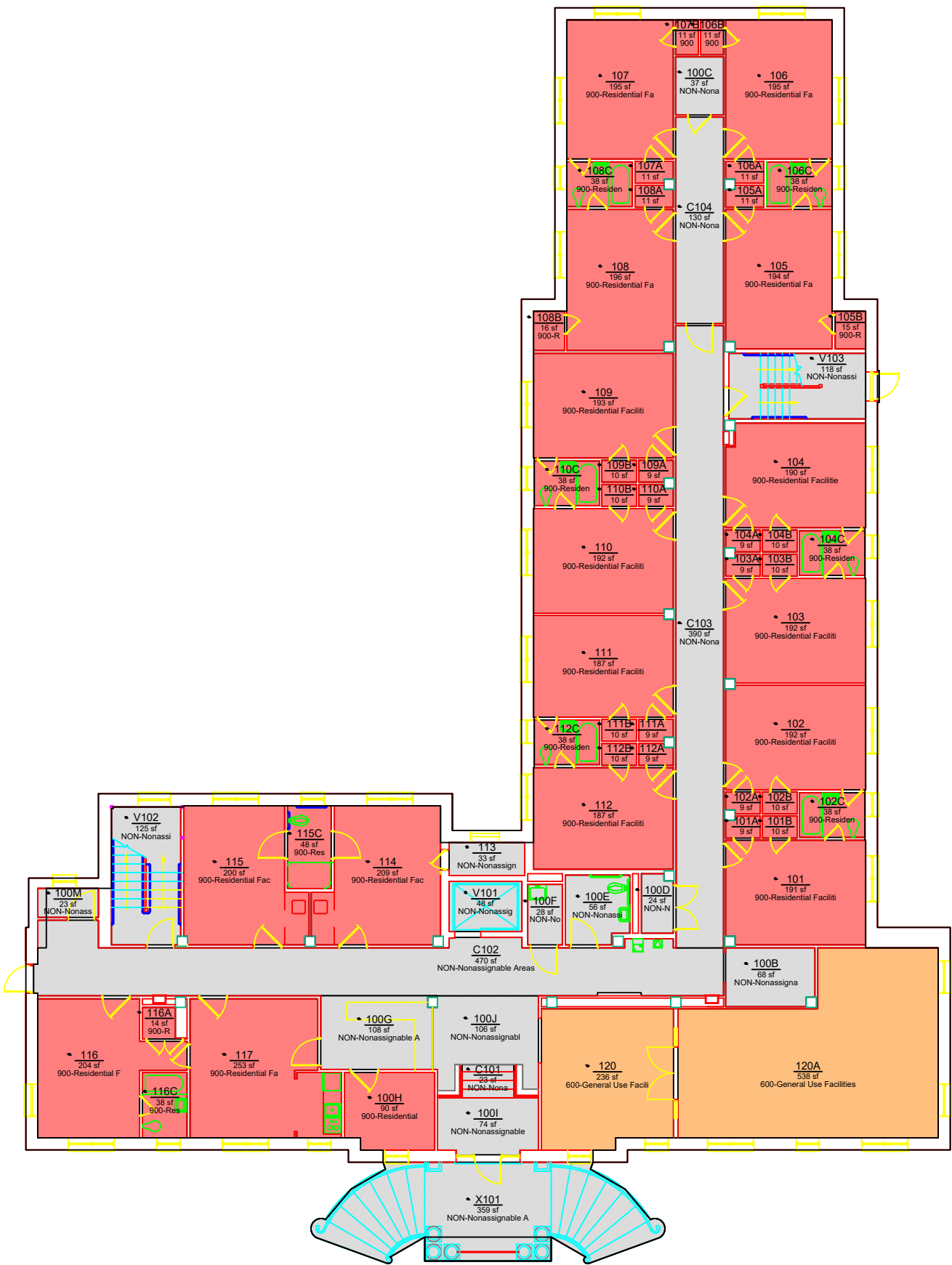

ROOM	ROOM CATEGORY
100B	NON-Nonassignable Areas
100C	NON-Nonassignable Areas
100D	NON-Nonassignable Areas
100E	NON-Nonassignable Areas
100F	NON-Nonassignable Areas
100G	NON-Nonassignable Areas
100H	900-Residential Facilities
100I	NON-Nonassignable Areas
100J	NON-Nonassignable Areas
100M	NON-Nonassignable Areas
101	900-Residential Facilities
101A	900-Residential Facilities
101B	900-Residential Facilities
102	900-Residential Facilities
102A	900-Residential Facilities
102B	900-Residential Facilities
102C	900-Residential Facilities
103	900-Residential Facilities
103A	900-Residential Facilities
103B	900-Residential Facilities
104	900-Residential Facilities
104A	900-Residential Facilities
104B	900-Residential Facilities
104C	900-Residential Facilities
105	900-Residential Facilities
105A	900-Residential Facilities
105B	900-Residential Facilities
106	900-Residential Facilities
106A	900-Residential Facilities
106B	900-Residential Facilities
106C	900-Residential Facilities
107	900-Residential Facilities
107A	900-Residential Facilities
107B	900-Residential Facilities
108	900-Residential Facilities
108A	900-Residential Facilities
108B	900-Residential Facilities
108C	900-Residential Facilities
109	900-Residential Facilities
109A	900-Residential Facilities
109B	900-Residential Facilities
110	900-Residential Facilities
110A	900-Residential Facilities
110B	900-Residential Facilities
110C	900-Residential Facilities
111	900-Residential Facilities
111A	900-Residential Facilities
111B	900-Residential Facilities
112	900-Residential Facilities
112A	900-Residential Facilities
112B	900-Residential Facilities
112C	900-Residential Facilities
113	NON-Nonassignable Areas
114	900-Residential Facilities
115	900-Residential Facilities
115C	900-Residential Facilities
116	900-Residential Facilities
116A	900-Residential Facilities
116C	900-Residential Facilities
117	900-Residential Facilities
120	600-General Use Facilities
C101	NON-Nonassignable Areas
C103	NON-Nonassignable Areas
C104	NON-Nonassignable Areas
V101	NON-Nonassignable Areas
V102	NON-Nonassignable Areas
V103	NON-Nonassignable Areas
X101	NON-Nonassignable Areas

End of chart



Office of the  
University Architect  
Facilities Management  
1161 West Samford Ave., Building 1  
Auburn, AL 36849

ROOM CATEGORY  
Glenn Residence Hall  
Level: 01

Building No.: AA\_W0602  
File Name: AA\_W0602\_01  
Last Export: 08/14/2015  
Report Created By: Ellen Doyle  
Report Date: 09/13/2018