

ROOM CATEGORY			
		AREA	QTY
<div></div>	100-CLASSROOM FACILITIES	452	1
<div></div>	200-LABORATORY FACILITIES	865	1
<div></div>	300-Office Facilities	5,767	33
<div></div>	400-Study Facilities	425	1
<div></div>	Non-Assignable Areas	4,692	19
TOTAL:		12,201	55
Floor Gross:		14,146	

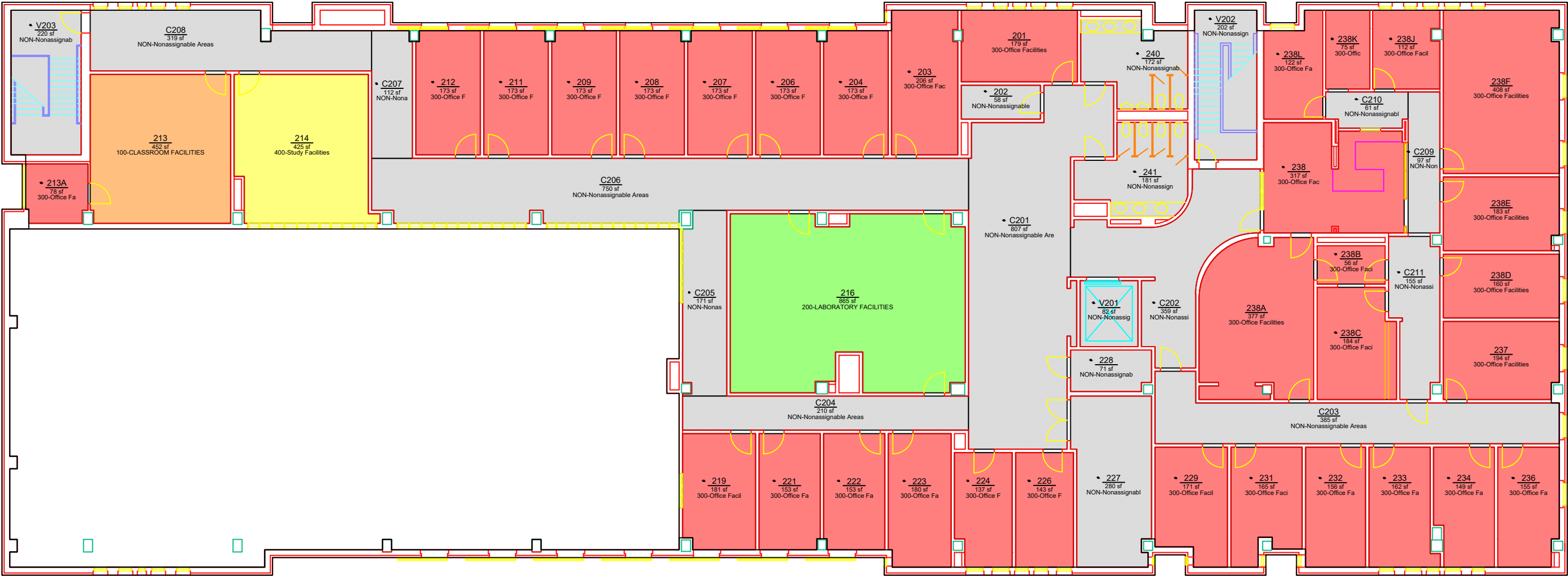

ROOM	ROOM CATEGORY	ROOM	ROOM CATEGORY	ROOM	ROOM CATEGORY
202	NON-Nonassignable Areas	231	300-Office Facilities	C211	NON-Nonassignable Areas
203	300-Office Facilities	232	300-Office Facilities	V201	NON-Nonassignable Areas
204	300-Office Facilities	233	300-Office Facilities	V202	NON-Nonassignable Areas
206	300-Office Facilities	234	300-Office Facilities	V203	NON-Nonassignable Areas
207	300-Office Facilities	236	300-Office Facilities	End of chart	
208	300-Office Facilities	238	300-Office Facilities		
209	300-Office Facilities	238B	300-Office Facilities		
211	300-Office Facilities	238C	300-Office Facilities		
212	300-Office Facilities	238J	300-Office Facilities		
213A	300-Office Facilities	238K	300-Office Facilities		
219	300-Office Facilities	238L	300-Office Facilities		
221	300-Office Facilities	240	NON-Nonassignable Areas		
222	300-Office Facilities	241	NON-Nonassignable Areas		
223	300-Office Facilities	C201	NON-Nonassignable Areas		
224	300-Office Facilities	C202	NON-Nonassignable Areas		
226	300-Office Facilities	C205	NON-Nonassignable Areas		
227	NON-Nonassignable Areas	C207	NON-Nonassignable Areas		
228	NON-Nonassignable Areas	C209	NON-Nonassignable Areas		
229	300-Office Facilities	C210	NON-Nonassignable Areas		



Office of the  
University Architect  
Facilities Management  
1161 West Samford Ave., Building 1  
Auburn, AL 36849

ROOM CATEGORY  
Harbert Center  
Level: 02

Building No.: AA_X0203
File Name: AA_X0203_02
Last Export: 11/30/2017
Report Created By: Ellen Doyle
Report Date: 09/13/2018