

ROOM CATEGORY		
	AREA	QTY
900-Residential Facilities	14,908	105
Non-Assignable Areas	2,851	10
TOTAL:	17,759	115
Floor Gross:	20,548	

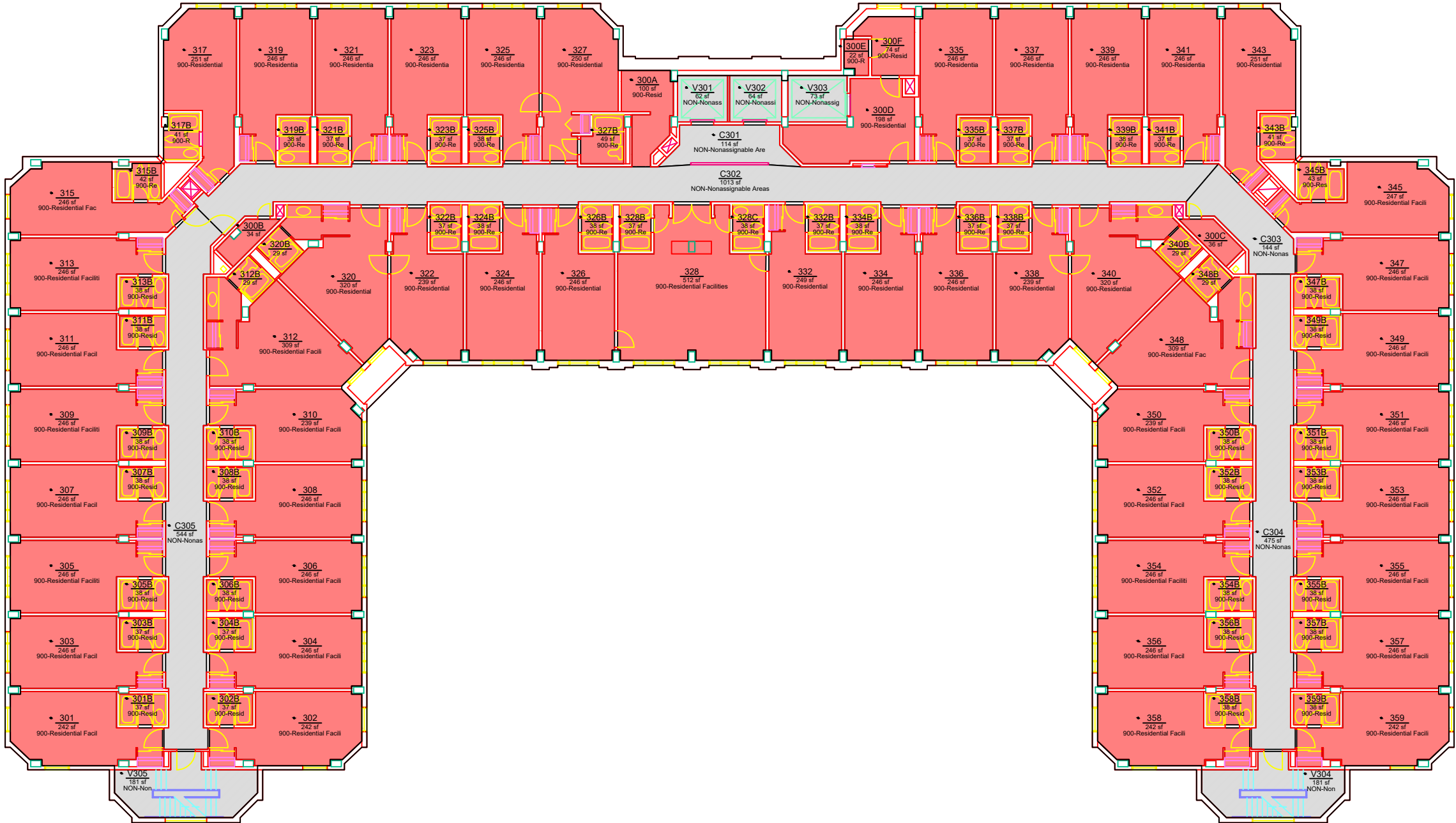

ROOM	ROOM CATEGORY
300A	900-Residential Facilities
300B	900-Residential Facilities
300C	900-Residential Facilities
300D	900-Residential Facilities
300E	900-Residential Facilities
300F	900-Residential Facilities
301	900-Residential Facilities
301B	900-Residential Facilities
302	900-Residential Facilities
302B	900-Residential Facilities
303	900-Residential Facilities
303B	900-Residential Facilities
304	900-Residential Facilities
304B	900-Residential Facilities
305	900-Residential Facilities
305B	900-Residential Facilities
306	900-Residential Facilities
306B	900-Residential Facilities
307	900-Residential Facilities
307B	900-Residential Facilities
308	900-Residential Facilities
308B	900-Residential Facilities
309	900-Residential Facilities
309B	900-Residential Facilities
310	900-Residential Facilities
310B	900-Residential Facilities
311	900-Residential Facilities
311B	900-Residential Facilities
312	900-Residential Facilities
312B	900-Residential Facilities
313	900-Residential Facilities
313B	900-Residential Facilities
314	900-Residential Facilities
314B	900-Residential Facilities
315	900-Residential Facilities
315B	900-Residential Facilities
316	900-Residential Facilities
316B	900-Residential Facilities
317	900-Residential Facilities
317B	900-Residential Facilities
318	900-Residential Facilities
318B	900-Residential Facilities
319	900-Residential Facilities
319B	900-Residential Facilities
320	900-Residential Facilities
320B	900-Residential Facilities
321	900-Residential Facilities
321B	900-Residential Facilities
322	900-Residential Facilities
322B	900-Residential Facilities
323	900-Residential Facilities
323B	900-Residential Facilities
324	900-Residential Facilities
324B	900-Residential Facilities
325	900-Residential Facilities
325B	900-Residential Facilities
326	900-Residential Facilities
326B	900-Residential Facilities
327	900-Residential Facilities
327B	900-Residential Facilities
328	900-Residential Facilities
328B	900-Residential Facilities
329	900-Residential Facilities
329B	900-Residential Facilities
330	900-Residential Facilities
330B	900-Residential Facilities
331	900-Residential Facilities
331B	900-Residential Facilities
332	900-Residential Facilities
332B	900-Residential Facilities
333	900-Residential Facilities
333B	900-Residential Facilities
334	900-Residential Facilities
334B	900-Residential Facilities
335	900-Residential Facilities
335B	900-Residential Facilities
336	900-Residential Facilities
336B	900-Residential Facilities
337	900-Residential Facilities
337B	900-Residential Facilities
338	900-Residential Facilities
338B	900-Residential Facilities
339	900-Residential Facilities
339B	900-Residential Facilities
340	900-Residential Facilities
340B	900-Residential Facilities
341	900-Residential Facilities
341B	900-Residential Facilities
342	900-Residential Facilities
342B	900-Residential Facilities
343	900-Residential Facilities
343B	900-Residential Facilities
344	900-Residential Facilities
344B	900-Residential Facilities
345	900-Residential Facilities
345B	900-Residential Facilities
346	900-Residential Facilities
346B	900-Residential Facilities
347	900-Residential Facilities
347B	900-Residential Facilities
348	900-Residential Facilities
348B	900-Residential Facilities
349	900-Residential Facilities
349B	900-Residential Facilities
350	900-Residential Facilities
350B	900-Residential Facilities
351	900-Residential Facilities
351B	900-Residential Facilities
352	900-Residential Facilities
352B	900-Residential Facilities
353	900-Residential Facilities
353B	900-Residential Facilities
354	900-Residential Facilities
354B	900-Residential Facilities
355	900-Residential Facilities
355B	900-Residential Facilities
356	900-Residential Facilities
356B	900-Residential Facilities
357	900-Residential Facilities
357B	900-Residential Facilities
358	900-Residential Facilities
358B	900-Residential Facilities
359	900-Residential Facilities
359B	900-Residential Facilities
C301	NON-Assignable Areas
C302	NON-Assignable Areas
C303	NON-Assignable Areas
C304	NON-Assignable Areas
C305	NON-Assignable Areas
V301	NON-Assignable Areas
V302	NON-Assignable Areas
V303	NON-Assignable Areas
V304	NON-Assignable Areas
V305	NON-Assignable Areas
End of chart	



Office of the
University Architect
Facilities Management
1161 West Samford Ave., Building 1
Auburn, AL 36849

ROOM CATEGORY
Hotel/Dixon Conference Center
Level: 03

Building No.: AA_Y0401
File Name: AA_Y0401_03
Last Export: 06/29/2015
Report Created By: Ellen Doyle
Report Date: 09/10/2018