

ROOM CATEGORY		
	AREA	QTY
900-Residential Facilities	14,898	105
Non-Assignable Areas	2,850	10
TOTAL:	17,748	115
Floor Gross:	20,548	

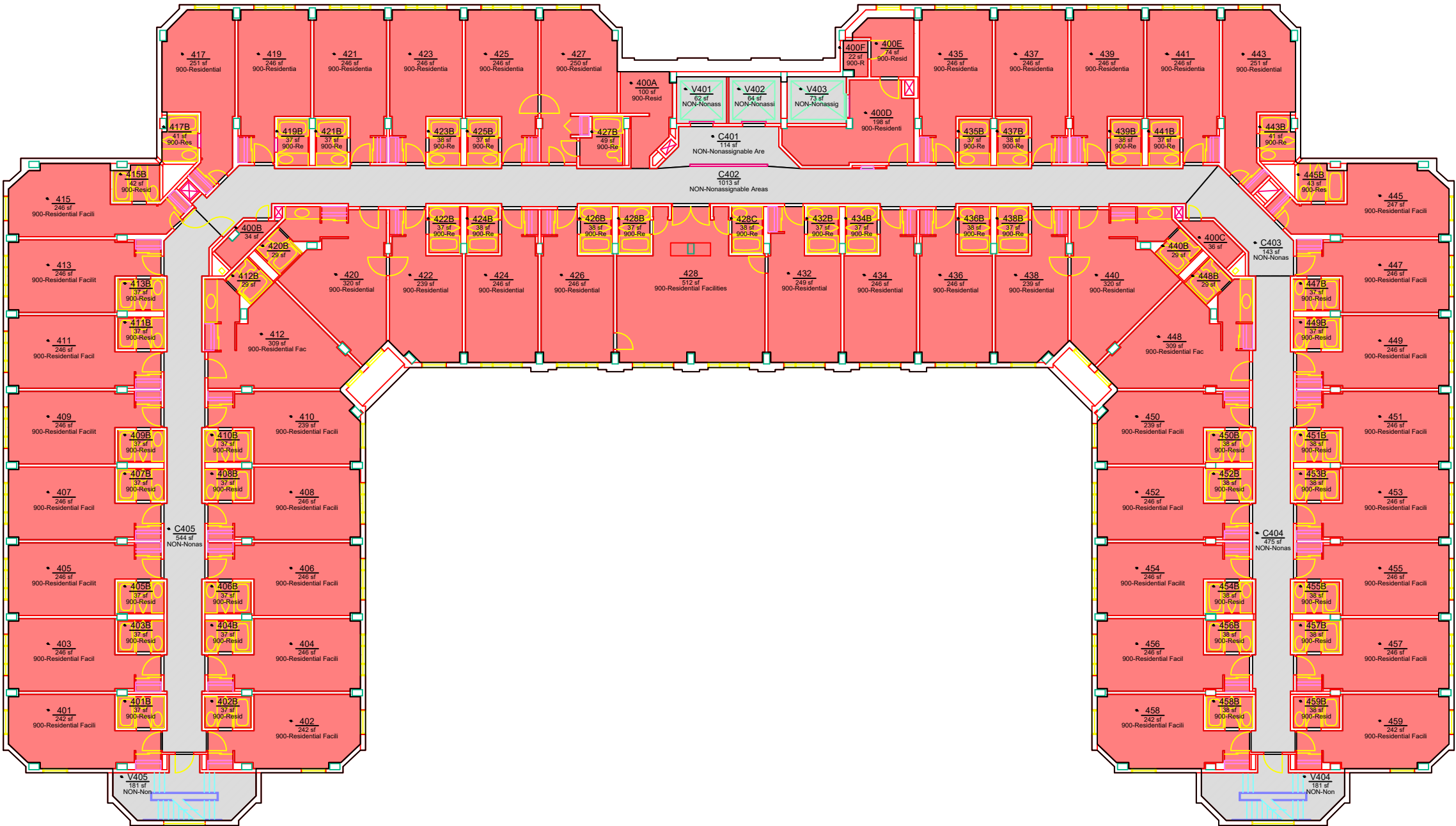

ROOM	ROOM CATEGORY
400A	900-Residential Facilities
400B	900-Residential Facilities
400C	900-Residential Facilities
400D	900-Residential Facilities
400E	900-Residential Facilities
400F	900-Residential Facilities
401	900-Residential Facilities
401B	900-Residential Facilities
402	900-Residential Facilities
402B	900-Residential Facilities
403	900-Residential Facilities
403B	900-Residential Facilities
404	900-Residential Facilities
404B	900-Residential Facilities
405	900-Residential Facilities
405B	900-Residential Facilities
406	900-Residential Facilities
406B	900-Residential Facilities
407	900-Residential Facilities
407B	900-Residential Facilities
408	900-Residential Facilities
408B	900-Residential Facilities
409	900-Residential Facilities
409B	900-Residential Facilities
410	900-Residential Facilities
410B	900-Residential Facilities
411	900-Residential Facilities
411B	900-Residential Facilities
412	900-Residential Facilities
412B	900-Residential Facilities
413	900-Residential Facilities
413B	900-Residential Facilities
415	900-Residential Facilities
415B	900-Residential Facilities
417	900-Residential Facilities
417B	900-Residential Facilities
419	900-Residential Facilities
419B	900-Residential Facilities
420	900-Residential Facilities
420B	900-Residential Facilities
421	900-Residential Facilities
421B	900-Residential Facilities
422	900-Residential Facilities
422B	900-Residential Facilities
423	900-Residential Facilities
423B	900-Residential Facilities
424	900-Residential Facilities
424B	900-Residential Facilities
425	900-Residential Facilities
425B	900-Residential Facilities
426	900-Residential Facilities
426B	900-Residential Facilities
427	900-Residential Facilities
427B	900-Residential Facilities
428	900-Residential Facilities
428B	900-Residential Facilities
428C	900-Residential Facilities
432	900-Residential Facilities
432B	900-Residential Facilities
434	900-Residential Facilities
434B	900-Residential Facilities
435	900-Residential Facilities
435B	900-Residential Facilities
436	900-Residential Facilities
436B	900-Residential Facilities
437	900-Residential Facilities
437B	900-Residential Facilities
438	900-Residential Facilities
438B	900-Residential Facilities
439	900-Residential Facilities
439B	900-Residential Facilities
440	900-Residential Facilities
440B	900-Residential Facilities
441	900-Residential Facilities
441B	900-Residential Facilities
443	900-Residential Facilities
443B	900-Residential Facilities
445	900-Residential Facilities
445B	900-Residential Facilities
447	900-Residential Facilities
447B	900-Residential Facilities
448	900-Residential Facilities
448B	900-Residential Facilities
449	900-Residential Facilities
449B	900-Residential Facilities
450	900-Residential Facilities
450B	900-Residential Facilities
451	900-Residential Facilities
451B	900-Residential Facilities
452	900-Residential Facilities
452B	900-Residential Facilities
453	900-Residential Facilities
453B	900-Residential Facilities
454	900-Residential Facilities
454B	900-Residential Facilities
455	900-Residential Facilities
455B	900-Residential Facilities
456	900-Residential Facilities
456B	900-Residential Facilities
457	900-Residential Facilities
457B	900-Residential Facilities
458	900-Residential Facilities
458B	900-Residential Facilities
459	900-Residential Facilities
459B	900-Residential Facilities
C401	NON-Assignable Areas
C402	NON-Assignable Areas
C403	NON-Assignable Areas
C404	NON-Assignable Areas
C405	NON-Assignable Areas
V401	NON-Assignable Areas
V402	NON-Assignable Areas
V403	NON-Assignable Areas
V404	NON-Assignable Areas
V405	NON-Assignable Areas
End of chart	



Office of the  
University Architect  
Facilities Management  
1161 West Samford Ave., Building 1  
Auburn, AL 36849

ROOM CATEGORY  
Hotel/Dixon Conference Center  
Level: 04

Building No.: AA\_Y0401  
File Name: AA\_Y0401\_04  
Last Export: 06/29/2015  
Report Created By: Ellen Doyle  
Report Date: 09/10/2018