

COLLEGE / DIVISION			
		AREA	QTY
<div></div>	111	1,165	14
<div></div>	Nonassignable Areas	239	3
TOTAL:		1,404	17
Floor Gross:		1,641	

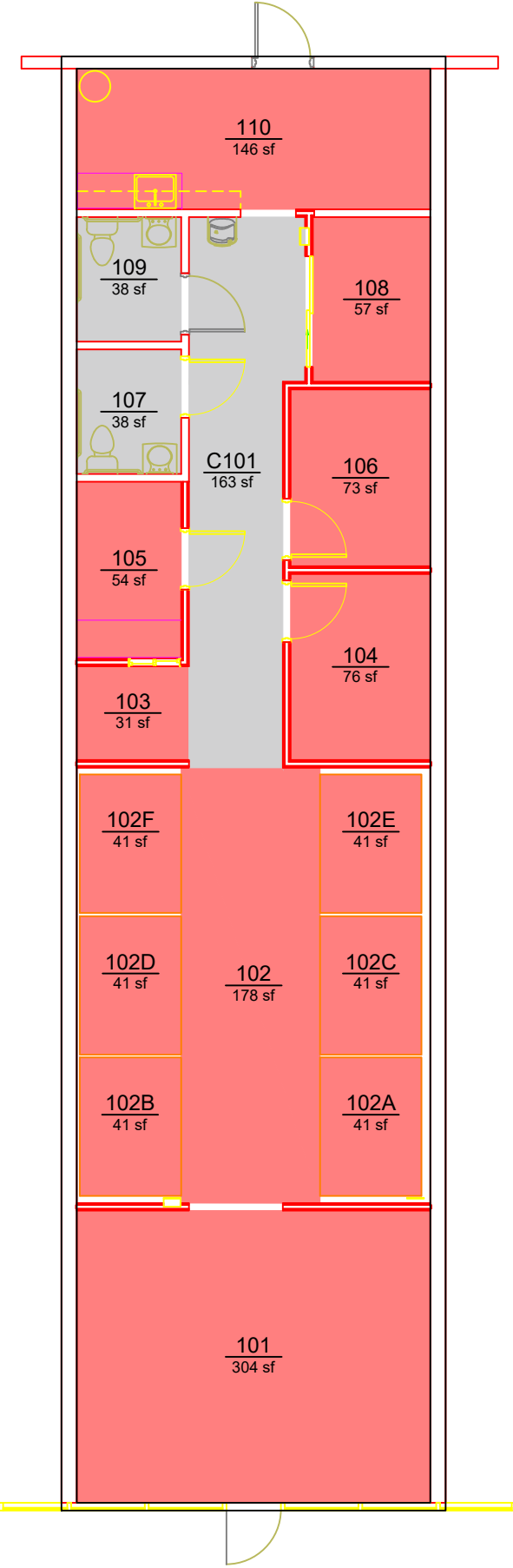

COLLEGE / DIVISION

AU ONBOARDING CENTER - EAST GLENN

LEVEL: 01



Planning, Design,
and Construction
Facilities Management
1161 West Samford Ave, Building 1
Auburn, AL 36849

Building No.: AC A0023
File Name: AC A0023_01
Last Export: 09/05/2023
Report Created By: Dan Berry
Report Date: 05/15/2025