

ROOM TYPE			
	AREA	QTY	
<div></div> 780 - Unit Storage	2,655	2	
<div></div> N20 - Corridor/General Circulation	554	3	
<div></div> N21 - Elevator	81	1	
<div></div> N22 - Interior Stairs/ Interior Ramp	621	2	
<div></div> N31 - Mechanical/ HVAC Room	11,806	1	
TOTAL:	15,717	9	
Floor Gross:	16,687		

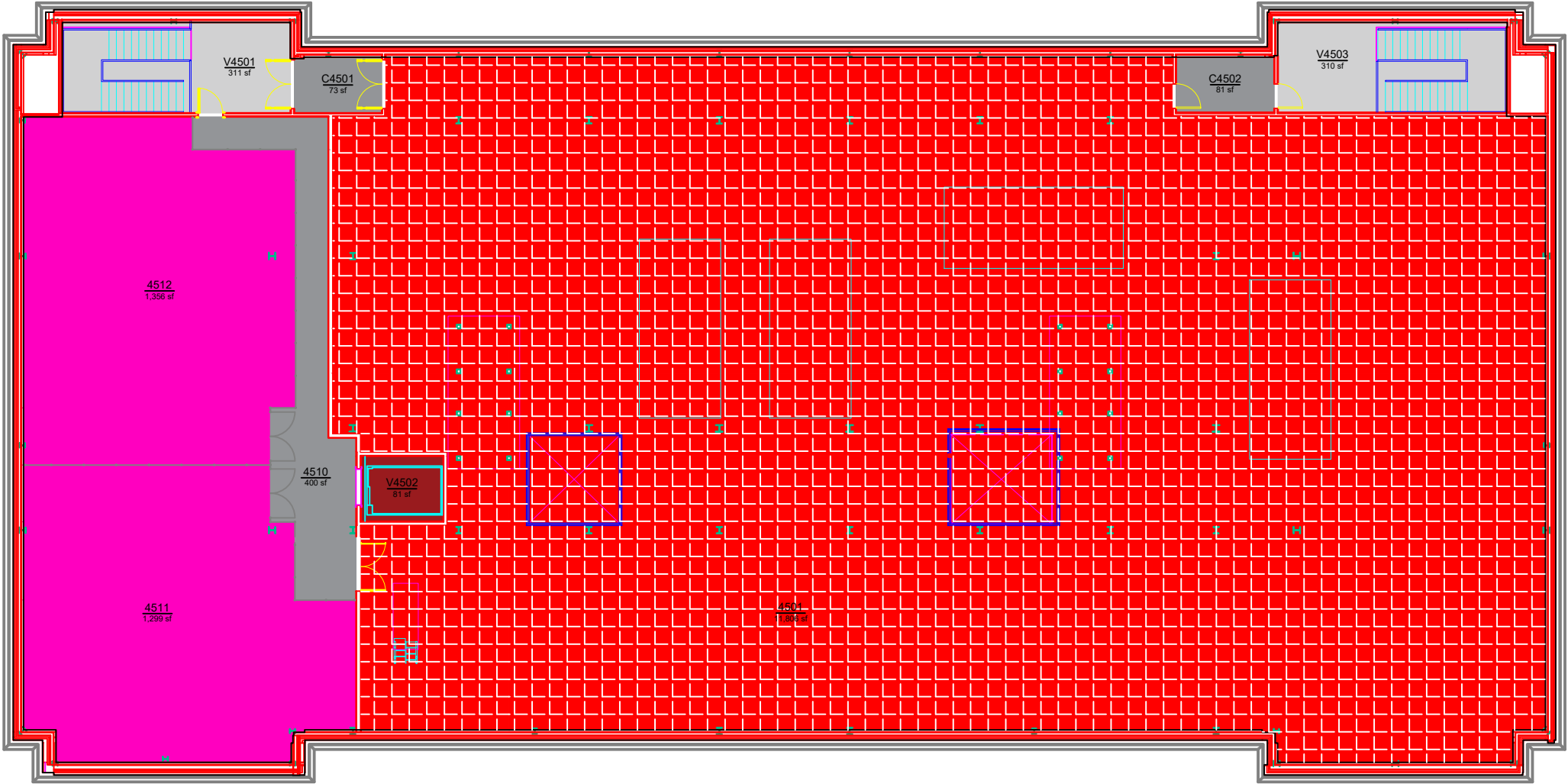

AUBURN  
UNIVERSITY

Campus Planning &  
Space Management  
Facilities Management  
1161 West Samford Ave, Building 1  
Auburn, AL 36849

ROOM TYPE

# WOLTOSZ ENGINEERING RESEARCH LABORATORY

LEVEL: 04

Building No.: AA\_V0305  
File Name: AA\_V0305\_04  
Last Export: 05/20/2023  
Report Created By: Ellen Doyle  
Report Date: 05/12/2025