

ORGANIZATION			
		AREA	QTY
<div></div>	000000 - NONASSIGNABLE AREAS	248	1
<div></div>	128601 - CIVIL ENGINEERING	4,643	1
TOTAL:		4,891	2
Floor Gross:		5,767	

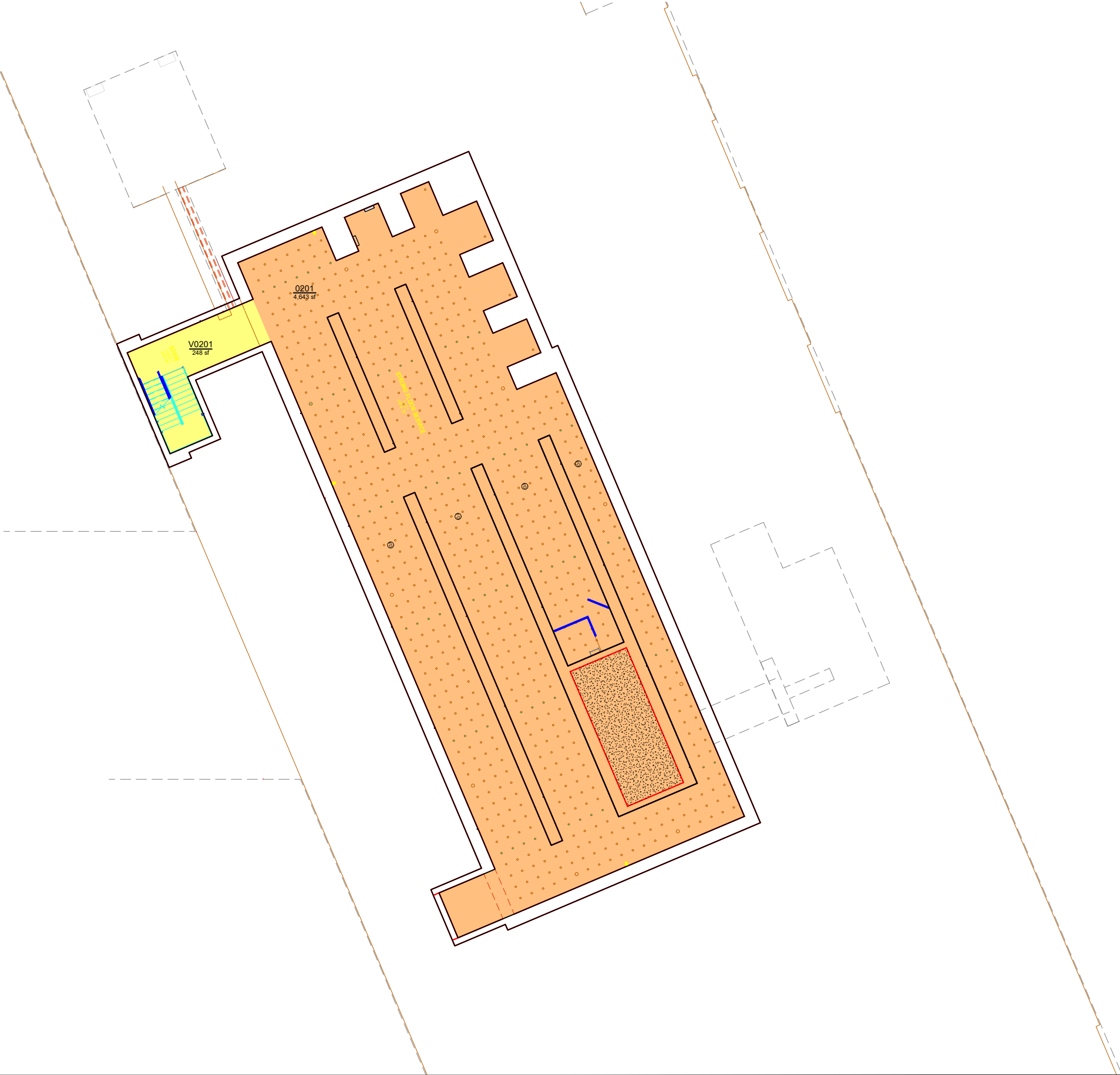

AUBURN
UNIVERSITY

Campus Planning &
Space Management
Facilities Management
1161 West Samford Ave, Building 1
Auburn, AL 36849

ORGANIZATION

ADVANCED STRUCTURAL ENGINEERING LABORATORY

LEVEL: 00

Building No.: AA_H0601
File Name: AA_H0601_00
Last Export: 05/21/2023
Report Created By: Amie Patterson
Report Date: 05/15/2025