

ORGANIZATION			
		AREA	QTY
<div></div>	000000 - NONASSIGNABLE AREAS	1,542	10
<div></div>	102024 - WORK MANAGEMENT	313	2
<div></div>	102036 - PREVENTIVE MAINTENANCE	1,628	7
<div></div>	102040 - MATERIALS MANAGEMENT	10,110	6
<div></div>	102055 - CAMPUS SERVICES	122	1
TOTAL:		13,715	26
Floor Gross:		14,661	

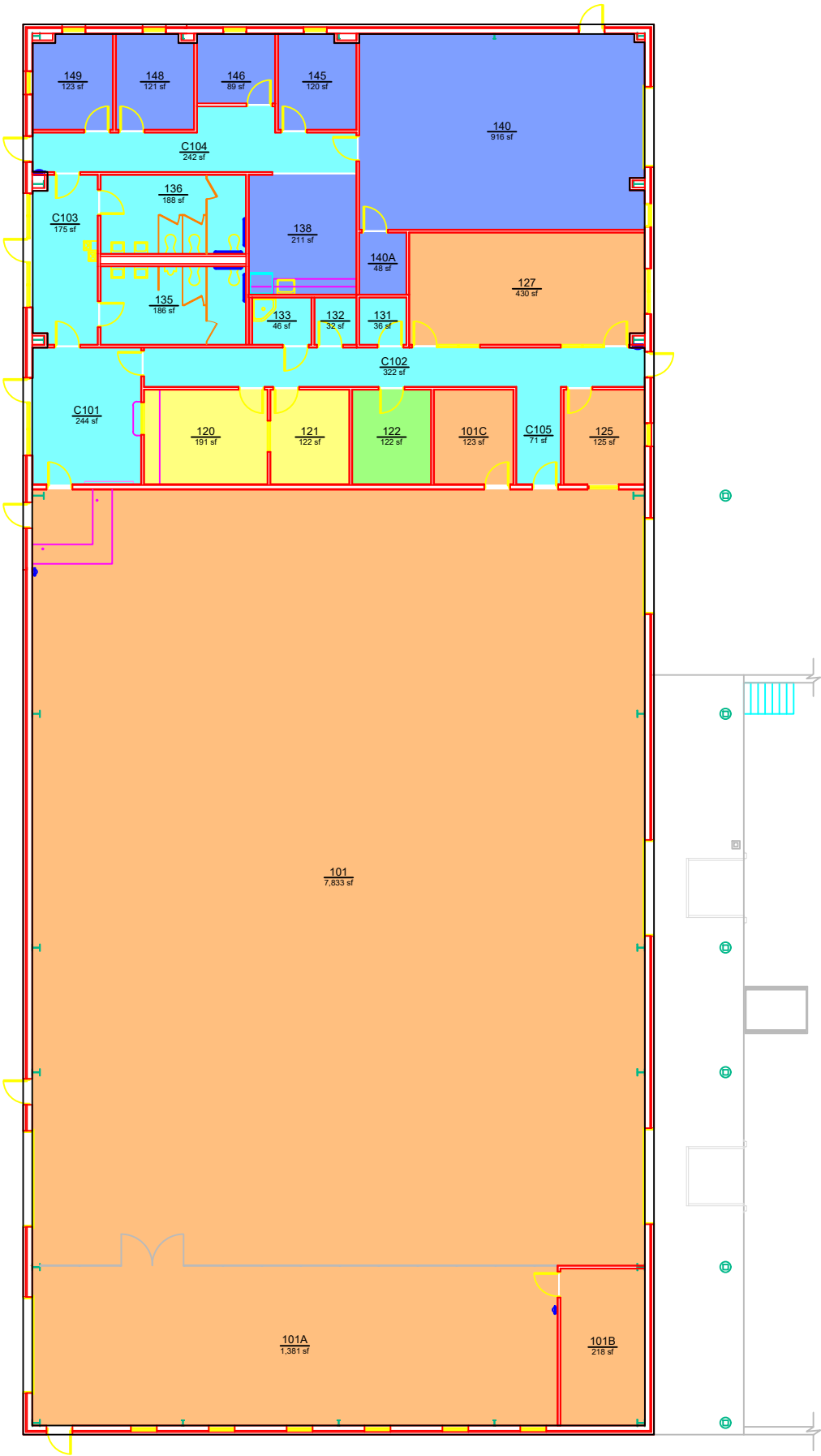

ORGANIZATION

FACILITIES MANAGEMENT: BUILDING 6

LEVEL: 01