

## Planned Outage and Interruption Request

Work Owner George Buster Reese Organization Facilities Phone 334-703-7212  
 Onsite Contact Brian Platt Phone 334-329-9354  
 Project # 24-402 Customer Request NA WO Number \_\_\_\_\_

### Select Interruption Type:

<b>Building System Outage or Space Closure</b> <small>(Only if part of a building is out, Check all that apply)</small>	<input type="checkbox"/>	Building Access Control	<input type="checkbox"/>	Elevator	<input type="checkbox"/>	Laboratory Utility	<input type="checkbox"/>	Sanitary Sewer
	<input type="checkbox"/>	Electric Power	<input type="checkbox"/>	Heating Ventilation & A/C (HVAC)	<input type="checkbox"/>	Natural Gas	<input type="checkbox"/>	Domestic Water
	<input type="checkbox"/>	Building Space/Entrances/ Occupant Flow	<input type="checkbox"/>	Telephone/IT	<input type="checkbox"/>	Fumehood	<input type="checkbox"/>	Cooler/Freezer
	<input type="checkbox"/>	Emergency Power <small>(Life Safety Approval required)</small>	<input type="checkbox"/>	Other <small>(Explain below)</small>	<input type="checkbox"/>		<input type="checkbox"/>	
<b>Utility Outage</b> <small>(If entire building is out)</small>	<input type="checkbox"/>	Electric Power	<input type="checkbox"/>	Natural Gas	<input type="checkbox"/>	Sewer from Building	<input type="checkbox"/>	Domestic Water
	<input type="checkbox"/>	Hot Water <small>(Central Plant)</small>	<input type="checkbox"/>	Chilled Water <small>(Central Plant)</small>	<input type="checkbox"/>	Steam <small>(Central Plant)</small>	<input type="checkbox"/>	Other <small>(Explain Below)</small>
<b>Outside Closures</b>	<input type="checkbox"/>	Roadway	<input type="checkbox"/>	Sidewalk	<input type="checkbox"/>	Bike Lane	<input type="checkbox"/>	Waste Receptacle
	<input checked="" type="checkbox"/>	Parking Spaces	<input type="checkbox"/>	ADA Facilities	<input type="checkbox"/>	Traffic Signal	<input type="checkbox"/>	Other <small>(Explain below)</small>
<b>Life Safety System Outage</b> <small>(Required any time system or components are taken out of service)</small>	<input type="checkbox"/>	Fire Alarm	<input type="checkbox"/>	Fire Suppression System and/or Fire Pump	<input type="checkbox"/>	Special Hazards Range Hood	<input type="checkbox"/>	Fire Hydrant
	<input type="checkbox"/>	Fire watch required? <input type="checkbox"/> Yes or <input type="checkbox"/> No <small>(Determined by Risk Management &amp; Safety and University Engineer)</small>				<input type="checkbox"/>	Note:	
<b>Life Safety Notifications</b>	<input type="checkbox"/>	Annual Fire Alarm Test and Inspection	<input type="checkbox"/>	Fire Suppression System Testing	<input type="checkbox"/>	Fire Alarm System Testing	<input type="checkbox"/>	Fire Alarm System Download
<b>Notifications</b>	<input type="checkbox"/>	Unplanned Outage	<input type="checkbox"/>	Preventative Maintenance	<input type="checkbox"/>	Risk Mgt. & Safety Inspection	<input type="checkbox"/>	Other <small>(Explain below)</small>

### Description of Work Activity

We need to have a loading zone for project 24-402. We are demolishing a structure next to Miller Hall

### Building(s) or Location(s) Affected

Six parking spaces along War Eagle Way

### Specific Space Affected (Room Numbers)

### How are the building clients or University stakeholders affected? What will they notice

Six parking spaces along War Eagle Way will be fenced off for approximately 45 days.

Schedule: 7/10/25 Start Date: 7/10/25 Start Time: 7:30 am End Date: 8/3/25 End Time: 5:00 pm

## Planned Outage and Interruption Request

### Planning Reviews (Per Review Matrix):

Organization	Review Required?	Reviewer	Review Date
Maintenance Zone Manager or Supervisor	NA		
Utility Supervisor	NA		
Others as Needed	Yes	Arishna Lastinger	6/3/25

### Client Approvals (Per Approval Matrix):

Organizations Affected by Work, Interruption, or Outage			
Client	Building(s)	Key Contact	Approval Date
	Miller Hall	Patricia James	Approved 7/10/2025
	Miller Hall	Julia Huff	VIA phone 7/10/2025
	Walker	Christopher Smith	VIA phone 7/10/2025

### Facilities Management Approvals (Per the Approval Matrix)

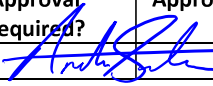
Facilities Management								
Maintenance			Utility and Energy			Design & Construction		
Approval Required?	Approved By:	Date	Approval Required?	Approved By:	Date	Approval Required?	Approved By:	Date
NA						Yes		7/11
Campus Services/Landscape								
Approval Required?	Approved By:	Date						
For Life Safety Systems								
University Engineer			Risk Management and Safety					
Approval Required?	Approved By:	Date	Approval Required?	Approved By:	Date			
Yes	McClure	7/10/2025						
Work Management								
Received By:		Date Received	Time Received		Date Notice Issued		Time Issued	

Work Owner Signature:  Date 6/4/25

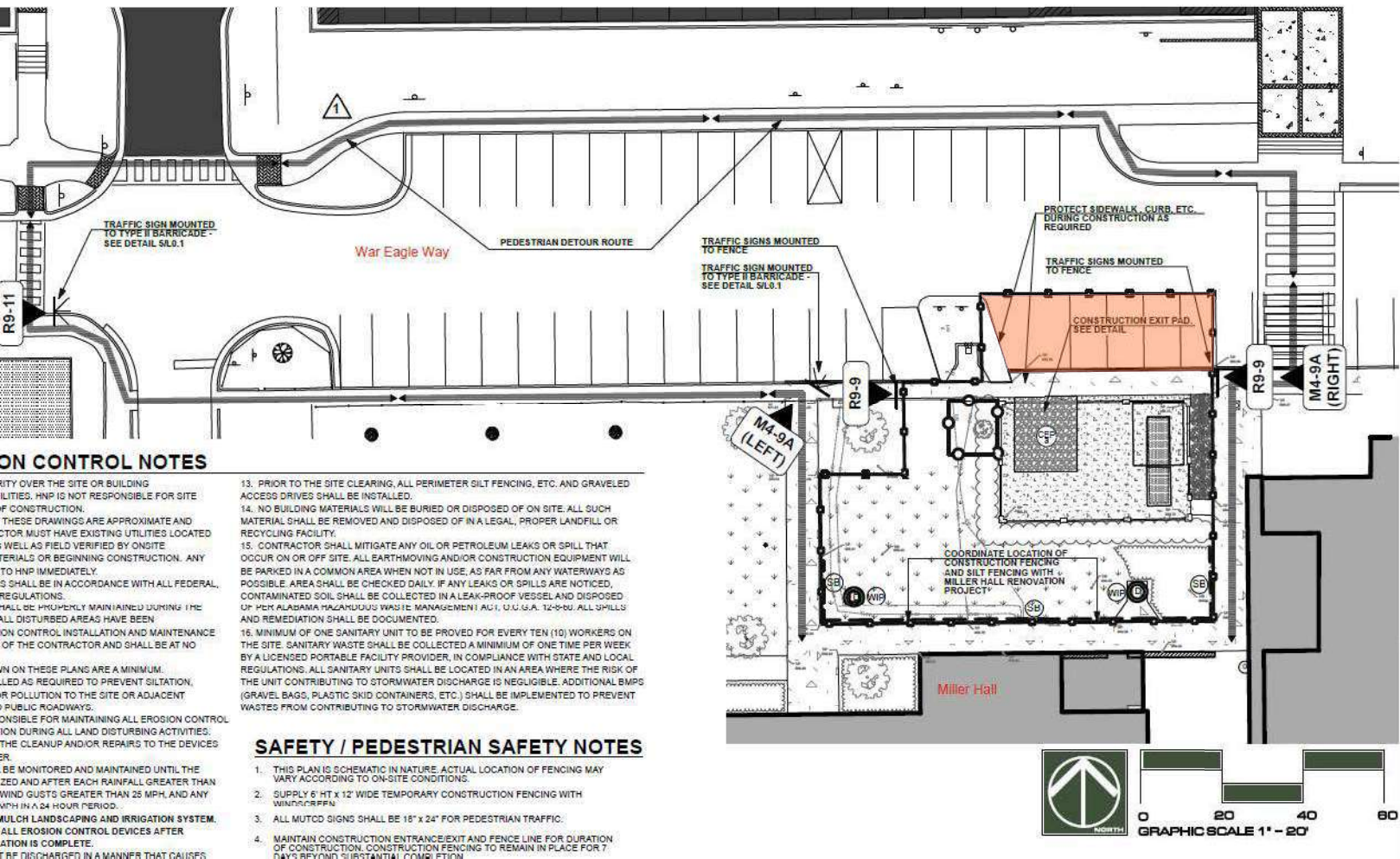

**From:** [Arishna Lastinger](#)  
**To:** [George Reese](#)  
**Subject:** RE: 24-402 parking space outage request  
**Date:** Tuesday, June 3, 2025 3:51:12 PM  
**Attachments:** [image002.png](#)  
[image003.png](#)  
[image004.png](#)  
[image005.png](#)

---

Hi Buster! I approve. Have those in Miller and Walker been notified and/or approved?



**Arishna Lastinger**

Director  
Parking Services  
330 Lem Morrison Drive  
O: 334.844.4196  
[ann0002@auburn.edu](mailto:ann0002@auburn.edu)  
[auburn.edu/parking](http://auburn.edu/parking)



---

**From:** George Reese <reesegp@auburn.edu>  
**Sent:** Tuesday, June 3, 2025 2:09 PM  
**To:** Arishna Lastinger <ann0002@auburn.edu>  
**Subject:** 24-402 parking space outage request

Arishna,

We are demolishing a brick enclosure near War Eagle Way and are requesting to close six parking spaces for approximately 45 days. We will need the spaces for laydown and haul out. There is also a safety concern since we will be working so close to the road.

Please let me know if you approve.

Thanks

**George "Buster" Reese, P.E.**

*Civil Engineer VI, Planning, Design, & Construction*

**Auburn University Facilities Management**

1161 W Samford Ave, Auburn University, AL 36849

C: 334-703-7212 | [reesegp@auburn.edu](mailto:reesegp@auburn.edu)

**From:** [Christopher Smith](#)  
**To:** [George Reese](#)  
**Subject:** Re: 24-402 Parking space outage request  
**Date:** Thursday, July 10, 2025 9:14:06 AM

---

I approve,

Chris Smith

**Chris Smith**  
*Research Operations Manager*  
*Division of Research*  
*Harrison College of Pharmacy*

*Pharmaceutical Research Building*  
*720 S. Donahue Dr., Room 103*  
*Auburn University, AL 36849*

*Office Phone: 334-844-8507*  
*Cell Phone: 334-740-5966*

---

**From:** George Reese <reesegp@auburn.edu>  
**Sent:** Thursday, July 10, 2025 9:08 AM  
**To:** Christopher Smith <cds0023@auburn.edu>  
**Subject:** FW: 24-402 Parking space outage request

Please see attached

Thanks

**George "Buster" Reese, P.E.**  
*Civil Engineer VI, Planning, Design, & Construction*  
**Auburn University Facilities Management**  
1161 W Samford Ave, Auburn University, AL 36849  
C: 334-703-7212 | [reesegp@auburn.edu](mailto:reesegp@auburn.edu)

---

**From:** George Reese  
**Sent:** Thursday, June 5, 2025 8:27 AM  
**To:** Patricia James <pmr0015@auburn.edu>; Julie Huff <hilljul@auburn.edu>; Christopher Smith <cds0023@auburn.edu>  
**Cc:** Arishna Lastinger <ann0002@auburn.edu>; Andrew Spurlin <jas0250@auburn.edu>  
**Subject:** 24-402 Parking space outage request

All,

The brick fence structure behind Miller Hall has become a safety concern. We have a project that will demolish and replace the fence structure. This work will impact approximately six parking space along War Eagle Way. As this work cannot be completed

**From:** [Julie Huff](#)  
**To:** [George Reese](#)  
**Subject:** Re: 24-402 Parking space outage request  
**Date:** Thursday, July 10, 2025 8:56:38 AM

---

Apologies, I missed this. Thanks for calling.

Julie Huff  
Asst. Provost, Academic Facilities, Operations & Initiatives  
301A Samford Hall  
Auburn University, AL 36849-5211  
(334) 844-5777  
[julie@auburn.edu](mailto:julie@auburn.edu)

Approved VIA  
phone

---

**From:** George Reese <[reesegp@auburn.edu](mailto:reesegp@auburn.edu)>  
**Date:** Thursday, June 5, 2025 at 8:27 AM  
**To:** Patricia James <[pmr0015@auburn.edu](mailto:pmr0015@auburn.edu)>, Julie Huff <[hilljul@auburn.edu](mailto:hilljul@auburn.edu)>, Christopher Smith <[cgs0023@auburn.edu](mailto:cds0023@auburn.edu)>  
**Cc:** Arishna Lastinger <[ann0002@auburn.edu](mailto:ann0002@auburn.edu)>, Andrew Spurlin <[jas0250@auburn.edu](mailto:jas0250@auburn.edu)>  
**Subject:** 24-402 Parking space outage request

All,

The brick fence structure behind Miller Hall has become a safety concern. We have a project that will demolish and replace the fence structure. This work will impact approximately six parking space along War Eagle Way. As this work cannot be completed safely without closing these six parking spaces we are requesting the attached parking space outage request for 45 days . Please review and e-mail if you approve or have any questions.

**George "Buster" Reese, P.E.**  
*Civil Engineer VI, Planning, Design, & Construction*  
**Auburn University Facilities Management**  
1161 W Samford Ave, Auburn University, AL 36849  
C: 334-703-7212 | [reesegp@auburn.edu](mailto:reesegp@auburn.edu)

**From:** [Patricia James](#)  
**To:** [George Reese](#); [Julie Huff](#); [Christopher Smith](#)  
**Cc:** [Arishna Lastinger](#)  
**Subject:** RE: 24-402 Parking space outage request  
**Date:** Thursday, July 10, 2025 9:21:57 AM

---

CLA approves.

Thank you

---

**From:** George Reese <reesegp@auburn.edu>  
**Sent:** Thursday, July 10, 2025 9:17 AM  
**To:** Patricia James <pmr0015@auburn.edu>; Julie Huff <hilljul@auburn.edu>; Christopher Smith <cds0023@auburn.edu>  
**Cc:** Arishna Lastinger <ann0002@auburn.edu>  
**Subject:** RE: 24-402 Parking space outage request

Just letting you know the dates have changed to 7/10-8/3

Thanks

**George "Buster" Reese, P.E.**  
*Civil Engineer VI, Planning, Design, & Construction*  
**Auburn University Facilities Management**  
1161 W Samford Ave, Auburn University, AL 36849  
C: 334-703-7212 | [reesegp@auburn.edu](mailto:reesegp@auburn.edu)

---

**From:** George Reese  
**Sent:** Thursday, June 5, 2025 8:27 AM  
**To:** Patricia James <[pmr0015@auburn.edu](mailto:pmr0015@auburn.edu)>; Julie Huff <[hilljul@auburn.edu](mailto:hilljul@auburn.edu)>; Christopher Smith <[cds0023@auburn.edu](mailto:cds0023@auburn.edu)>  
**Cc:** Arishna Lastinger <[ann0002@auburn.edu](mailto:ann0002@auburn.edu)>; Andrew Spurlin <[jas0250@auburn.edu](mailto:jas0250@auburn.edu)>  
**Subject:** 24-402 Parking space outage request

All,

The brick fence structure behind Miller Hall has become a safety concern. We have a project that will demolish and replace the fence structure. This work will impact approximately six parking space along War Eagle Way. As this work cannot be completed safely without closing these six parking spaces we are requesting the attached parking space outage request for 45 days . Please review and e-mail if you approve or have any questions.

**George "Buster" Reese, P.E.**  
*Civil Engineer VI, Planning, Design, & Construction*  
**Auburn University Facilities Management**  
1161 W Samford Ave, Auburn University, AL 36849

**From:** [Scott McClure](#)  
**To:** [George Reese](#)  
**Subject:** Re:  
**Date:** Thursday, July 10, 2025 12:33:28 PM

---

I approve

--

Best Regards,  
Scott McClure, PE, CEM  
Maintenance Engineer, Maintenance  
Auburn University Facilities Management  
Cell: [404-966-5654](tel:404-966-5654)

On Jul 10, 2025, at 12:17 PM, George Reese <[reeseqp@auburn.edu](mailto:reeseqp@auburn.edu)> wrote:

Please review and let me know if you approve  
Thanks

**George "Buster" Reese, P.E.**  
*Civil Engineer VI, Planning, Design, & Construction*  
**Auburn University Facilities Management**  
1161 W Samford Ave, Auburn University, AL 36849  
C: 334-703-7212 | [reeseqp@auburn.edu](mailto:reeseqp@auburn.edu)

<24-402 parking outage request v3.pdf>